

PERFECT MEETINGS AND EVENTS

CREATIVE
SOLUTIONS FOR
IMPECCABLE EVENTS

parkplaza.com

Park Plaza
Hotels & Resorts

INDEX

PRIVATE EVENTS	4
CORPORATE SOCIAL RESPONSIBILITY	6
RESTAURANTS & BARS	8
FREE WI-FI	10
RADISSON REWARDS	11
art'otel	12
THE BEST ONLINE RATE – GUARANTEED	13
CAPACITY OVERVIEW	16

CROATIA

Park Plaza Histria Pula	Pula	20
Park Plaza Belvedere Medulin	Medulin	22

GERMANY

Park Plaza Berlin Kudamm	Berlin	26
Park Plaza Wallstreet Berlin Mitte	Berlin	28
Park Plaza Nuremberg	Nuremberg	30
Park Plaza Trier	Trier	32

THE NETHERLANDS

Park Plaza Victoria Amsterdam	Amsterdam	36
Park Plaza Vondelpark, Amsterdam	Amsterdam	38
Park Plaza Amsterdam Airport	Amsterdam	40
Park Plaza Eindhoven	Eindhoven	42
Park Plaza Utrecht	Utrecht	44

UNITED KINGDOM

Park Plaza Cardiff	Cardiff	48
Park Plaza Leeds	Leeds	50
Park Plaza County Hall London	London	52
Park Plaza London Park Royal	London	54
Park Plaza London Riverbank	London	56
Park Plaza London Waterloo	London	58
Park Plaza Victoria London	London	60
Park Plaza Westminster Bridge London	London	62
Park Plaza Nottingham	Nottingham	64
Plaza On The River	London	66

CONTACT

67



KEY FEATURES

- HEALTH / FITNESS CLUB
- SPA
- POOL
- BUSINESS CENTRE
- ON-SITE PARKING
- FREE WI-FI
- 100% NON-SMOKING
- ROOM SERVICE





WELCOME TO PARK PLAZA® HOTELS & RESORTS

At Park Plaza® Hotels & Resorts we specialise in delivering outstanding meetings and event facilities throughout our stylish collection of European hotels. Our flexible spaces are ideal for meetings, conferences, social gatherings and training sessions, and with a host of locations to choose from we guarantee you'll find the perfect solution. Our brilliant chefs design bespoke menus, we pour inspiration and creativity into our breakout sessions and our dedicated meeting planners take care of the finest details.

That's why we're one of Europe's most respected meetings and events providers. Why not check out how we can help you ensure that your next event is the best one yet?

Take a 360° virtual tour and explore Park Plaza online:

[parkplaza.com/virtualtours](https://www.parkplaza.com/virtualtours)

[parkplaza.com/watch-our-videos](https://www.parkplaza.com/watch-our-videos)

OUR COMMITMENT

WE'LL RESPOND TO YOUR ENQUIRY WITHIN ONE HOUR, AND WE'LL DELIVER OUR PROPOSAL WHEN YOU NEED IT.

YOU'LL HAVE A DEDICATED MEETINGS SPECIALIST FOR YOUR EVENT.

WE'LL OFFER ON-THE-SPOT SOLUTIONS ON THE DAY.

WE'LL CREATE A PERSONALISED WEB PAGE FOR YOUR EVENT ON REQUEST.

WE'LL DELIVER INSPIRATIONAL TEA AND COFFEE BREAKS.

YOU'LL RECEIVE A CONCISE, ITEMISED INVOICE WITHIN THREE DAYS OF YOUR EVENT.

PRIVATE EVENTS

WHATEVER YOU'RE CELEBRATING, WE HAVE THE ULTIMATE VENUE. IF YOU'RE LOOKING FOR AN IDYLIC SETTING IN WHICH TO SAY 'I DO', TO MARK A LANDMARK BIRTHDAY OR TO TOAST A SPECIAL ANNIVERSARY, OUR HOTELS ACROSS EUROPE WILL MAKE IT A DAY TO REMEMBER.



LET'S
CELEBRATE



From romantic ceremonies to unforgettable wedding nights, Park Plaza® Hotels & Resorts invites you to make the ultimate commitment. Whether it's a fairytale wedding overlooking the River Thames or an intimate evening with close friends and family we can stage the day you've always dreamt about. Many of our hotels are licensed for weddings and civil ceremonies and offer breathtaking reception spaces as well as once-in-a-lifetime wedding nights in our Bridal and Honeymoon Suites.

If you're hosting an anniversary, birthday, bar mitzvah or retirement party, our contemporary spaces can be tailored to suit your guest list. Dine in our award-winning restaurants and bars or challenge our talented chefs to design a fitting menu especially for your event. Stay with us and enjoy our luxuriously contemporary guestrooms and suites before escaping to our tranquil spas and state-of-the-art fitness centres. However you envisage marking your special event, it's your party your way.

Learn more at
[parkplaza.com/weddings-and-anniversaries](https://www.parkplaza.com/weddings-and-anniversaries)

CORPORATE SOCIAL RESPONSIBILITY

AS A LOCAL PLAYER WITH GLOBAL REACH, WE'RE DEDICATED TO MINIMISING THE IMPACT OUR HOTELS HAVE ON THE ENVIRONMENT AND THE COMMUNITIES IN WHICH THEY OPERATE. OUR 'GREEN TEAMS' ARE TASKED WITH ROLLING OUT ENERGY-SAVING LIGHTING, REDUCING PACKAGING, INSTALLING WATER-SAVING DEVICES AND INTRODUCING OSMOSIS SYSTEMS IN KITCHENS.

Our Total Responsibility for Everyone's Environment (TREE) initiative is the central principle of our sustainable business strategy. Under TREE we guarantee that team members are motivated to reduce resource consumption and waste, support local communities and ensure that each of our 2,500 team members is working in an ethically fair environment with equal access to training and personal development.

THINK GREEN



RESTAURANTS & BARS

OUR BUZZING CONTEMPORARY RESTAURANTS AND BARS OFFER DINING EXPERIENCES BEYOND COMPARE. AND WHEN IT COMES TO MEETINGS AND EVENTS, WE TAILOR ALL MENUS AND BREAKOUT SESSIONS TO YOUR SPECIFIC REQUIREMENTS. WHETHER IT'S COFFEE BREAKS WITH LIGHT BITES AND DRINKS, ENERGISING LUNCHES OR RELAXING AFTERNOON TEAS, WE GUARANTEE YOU FOOD FOR THOUGHT.



FOOD FOR THOUGHT



We're passionate about food. Throughout all our hotels, our talented chefs imbue every dish with unique flair and creativity. That's why our restaurants regularly receive the most coveted industry awards.

Our innovative Pan-Asian Chino Latino® Restaurant & Bar is adored by diners and critics, while the freshest ingredients dance on your palate at Brasserie Joël. Ichi Sushi and Sashimi Bar's just-caught fish and heavenly fragrant rice bring a touch of Tokyo to London, and TOZI's all-Italian wine list is the perfect accompaniment to its menu of delightful Venetian-inspired cicchetti. The settings are contemporary, the service is exemplary, but it's the food that takes centre stage.

From a vibrant city bar to an atmospheric alfresco terrace, our exceptional mixologists create dazzling cocktails to fit your mood. Add a dash of live entertainment and unlimited laughter and you have the ultimate venue.

Awards

- ONE AA ROSETTE**
Laguna Kitchen & Bar
Park Plaza Cardiff
- Florentine Restaurant
Park Plaza London Waterloo
- TWO AA ROSETTES**
Brasserie Joël
Park Plaza Westminster Bridge London
- Chino Latino® Restaurant & Bar
Park Plaza Nottingham
- Chino Latino® Restaurant & Bar
Park Plaza Riverbank London
- TOZI Restaurant & Bar
Park Plaza Victoria London
- L'Italiano
Park Plaza County Hall London

FREE WI-FI



WE UNDERSTAND THAT LIFE DOESN'T STAND STILL WHILE YOU'RE TRAVELLING. THAT'S WHY WE OFFER COMPLIMENTARY WIRELESS INTERNET IN OUR GUESTROOMS, PUBLIC AREAS AND MEETING SPACES AT ALL OUR HOTELS IN EUROPE. WHAT'S MORE, YOU DON'T EVEN NEED TO CHECK-IN TO ENJOY FREE WI-FI WITH US – SIMPLY POP IN TO THE LOBBY, RESTAURANT OR BAR AND GET ONLINE FOR FREE WHEN YOU PURCHASE A MEAL OR DRINK.

VISIT PARKPLAZA.COM/CONNECTFORFREE TO LEARN MORE.

A photograph of a modern hotel lobby desk. On the dark, polished desk, there is an open laptop, two white coffee cups on saucers, and a folded newspaper. In the background, a vase with white orchids sits on a ledge. Large windows offer a view of a city street. The overall atmosphere is clean, professional, and comfortable.

STAY CONNECTED

RADISSON
REWARDS™
FOR BUSINESS

plan on more rewards

Get ready to earn rewards for your meetings and events.

From boardrooms to ballrooms, small meetings to large conventions—we've got your event covered. With Radisson Rewards™ for Business, you can earn 5 points per U.S. dollar spent for the meetings and events you book at any of our more than 1,100 hotels worldwide.

Learn more and join today at radissonhotels.com/rewards/meetings



RADISSON
REWARDS

RADISSONHOTELS.COM

RADISSON
MEETINGS

art'otel

amsterdam
berlin
budapest
cologne

Broaden your horizons
With a seamless fusion of art and life, art'otel provides creative spaces for meetings and events in cosmopolitan centres across Europe. Add in world-class hospitality, outstanding cuisine and exceptional personal service and we guarantee your delegates will be inspired to greatness.

artotels.com

THE BEST ONLINE RATE — GUARANTEED!

WE KNOW THAT, AS SAVVY TRAVELLERS, YOU'RE ALWAYS LOOKING FOR THE BEST DEAL. THAT'S WHY WE GUARANTEE THAT YOU CAN BOOK WITH CONFIDENCE AT PARKPLAZA.COM. IN FACT, WE'RE SO ADAMANT THAT YOU WON'T FIND A BETTER ONLINE RATE ANYWHERE ELSE THAT IF YOU DO WE'LL MATCH THE RATE YOU FIND AND WE'LL DISCOUNT IT BY 25%.

VISIT [PARKPLAZA.COM/BEST-RATE](https://www.parkplaza.com/best-rate) FOR MORE DETAILS.

OUR GUARANTEE









MEET

EUROPE AND THE MIDDLE EAST

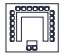

CAPACITY OVERVIEW

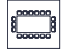
FROM BOARDROOMS TO BALLROOMS AND CLASSROOM TO THEATRE-STYLE, WE'VE THE PERFECT SPACE TO HOST YOUR EVENT. CHOOSE FROM A BUSTLING CITY CENTRE, A COASTAL RETREAT IN CROATIA OR A HISTORIC LONDON SETTING - WHEREVER YOU DECIDE TO WELCOME YOUR DELEGATES, YOU'RE GUARANTEED OUTSTANDING FACILITIES, AWARD-WINNING MENUS AND HIGHLY PERSONALISED SERVICE. SIMPLY REVIEW THE CAPACITY CHART OPPOSITE AND CONTACT US TO DISCUSS YOUR REQUIREMENTS.

- | | | | | | |
|---|------------|---|-----------|---|--------------|
|  | THEATRE |  | U-SHAPE |  | DINNER |
|  | PARLIAMENT |  | CLASSROOM |  | DINNER DANCE |
|  | BOARDROOM |  | CABARET |  | RECEPTION |

LET'S GET TOGETHER

CITY	HOTEL	GUEST ROOMS	MEETING ROOMS	THEATRE	PARLIAMENT	BOARD ROOM	U-SHAPE	CLASS-ROOM	CABARET	DINNER	DINNER DANCE	RECEPTION	DISTANCE TO AIRPORT (KM)	DISTANCE TO TRAIN STATION (KM)	TELEPHONE	EMAIL
CROATIA																
MEDULIN	PARK PLAZA BELVEDERE MEDULIN	427	5	120	-	25	40	60	-	80	-	-	15	-	+385 (0) 52 572 001	meetingscroatia@pphe.com
PULA	PARK PLAZA HISTRIA PULA	368	4	700	350	65	200	350	280	-	-	-	13	-	+385 (0) 52 590 000	meetingscroatia@pphe.com
GERMANY																
BERLIN	PARK PLAZA BERLIN KUDAMM	133	3	116	-	30	35	40	-	80	-	100	-	-	+49 (0) 30 88447 0	ppbkconf@pphe.com
BERLIN	PARK PLAZA WALLSTREET BERLIN MITTE	167	5	140	80	60	70	80	60	80	-	140	14	2	+49 (0) 30 847 1170	ppwbconf@pphe.com
NUREMBERG	PARK PLAZA NUREMBERG	177	7	80	-	30	30	-	-	-	-	80	10	0.1	+49 (0) 911 21 555 0	ppnuconf@pphe.com
TRIER	PARK PLAZA TRIER	150	8	216	180	50	44	176	128	200	180	250	40	2.5	+49 (0) 651 999 30	bankett@parkplaza-trier.de
THE NETHERLANDS																
AMSTERDAM	PARK PLAZA AMSTERDAM AIRPORT	342	18	700	300	40	130	200	180	350	-	-	7	7	+31 (0) 20 655 1007	meetingsamsterdam@pphe.com
AMSTERDAM	PARK PLAZA VICTORIA AMSTERDAM	306	11	130	80	56	46	70	70	80	-	120	20	0.1	+31 (0) 20 655 1007	meetingsamsterdam@pphe.com
AMSTERDAM	PARK PLAZA VONDELPARK, AMSTERDAM	138	3	48	56	28	32	24	36	-	-	100	13	4	+31 (0) 20 655 1007	meetingsamsterdam@pphe.com
EINDHOVEN	PARK PLAZA EINDHOVEN	104	4	75	40	35	30	40	50	-	-	50	8	0.8	+31 (0) 40 214 6500	ppmeetings@pphe.com
UTRECHT	PARK PLAZA UTRECHT	120	11	120	110	55	42	120	120	110	-	-	46	0.1	+31 (0) 30 292 5170	ppumeetings@pphe.com
UNITED KINGDOM																
CARDIFF	PARK PLAZA CARDIFF	129	11	160	-	48	30	70	80	150	150	250	20	1.1	+44 (0) 292 011 1111	ppconf@parkplazahotels.co.uk
LEEDS	PARK PLAZA LEEDS	187	11	200	-	50	40	72	120	220	160	350	18	0.1	+44 (0) 333 400 6144	pplconf@pphe.com
LONDON	PARK PLAZA COUNTY HALL LONDON	399	7	100	-	40	36	60	64	80	-	100	27	0.3	+44 (0) 333 400 6116	ppchconf@pphe.com
LONDON	PARK PLAZA LONDON WATERLOO	494	6	120	-	54	40	-	88	120	100	200	14	0.15	+44 (0) 333 400 6128	ppwainfo@pphe.com
LONDON	PARK PLAZA LONDON PARK ROYAL	212	4	48	-	16	15	-	20	40	-	55	22	0.2	+44 (0) 845 241 3328	ppprinfo@pphe.com
LONDON	PARK PLAZA LONDON RIVERBANK	395	23	650	-	60	64	300	432	540	490	660	27	0.5	+44 (0) 333 400 6120	pprlconf@pphe.com
LONDON	PARK PLAZA VICTORIA LONDON	299	15	550	-	64	64	260	280	400	350	750	26	0.2	+44 (0) 333 400 6140	ppvlconf@pphe.com
LONDON	PARK PLAZA WESTMINSTER BRIDGE LONDON	1019	31	2000	-	40	30	800	720	1350	1220	1500	27	0.5	+44 (0) 333 400 6112	ppwlconf@pphe.com
LONDON	PLAZA ON THE RIVER	110	23	650	-	60	64	-	432	540	490	660	27	0.6	+44 (0) 20 7769 2525	sales@plazaontheriver.co.uk
NOTTINGHAM	PARK PLAZA NOTTINGHAM	178	12	185	-	30	54	90	108	170	170	220	24	1	+44 (0) 333 400 6148	ppnconf@pphe.com



CROATIA

CROATIA

Renowned for its mild climate and spectacular views, the Croatian coastline is bursting with hidden treasures, from Roman villas and temples to hundreds of tiny islands. And with the crystal-clear Adriatic Sea offering fishing, sailing to secluded coves, and wreck dives to ancient Roman galleys and first-world-war battleships, there is no better place to immerse yourself in a natural paradise.

Increasingly popular as a meetings and incentives destination, this Adriatic haven offers tranquility and seclusion, allowing delegates to enjoy the best of both worlds – excellent facilities coupled with outstanding leisure opportunities. Romantic couples, meanwhile, will find no more enchanting a setting for the wedding of their dreams.

Discover more of the magic of Croatia at parkplaza.com/croatia



PARK PLAZA HISTRIA PULA

AN IDYLIC EVENTS VENUE CLOSE TO THE ANCIENT CITY OF PULA BOASTING A CHOICE OF MEETING ROOMS AND A PURPOSE-BUILT HALL FOR LARGE CONFERENCES

With breathtaking views of the Adriatic, Park Plaza Histria Pula offers an enchanting setting for meetings, conferences and special events. The hotel's three meeting rooms can host up to 100 delegates, while 700 guests can be accommodated in the impressive congress hall.

- Four contemporary meeting rooms totalling 740m²
- On-site parking
- Overlooking the majestic Adriatic coastline just 13km from Pula Airport
- 368 contemporary guestrooms and suites
- Guestrooms have private, furnished balconies with sea views
- Two restaurants and a choice of bars
- Two salt water pools, fitness centre, sauna and spa
- Access to the aqua park, sports pitches and Kids' Club at the neighbouring Park Plaza Verudela Pula
- Explore the range of shops, boutiques, art galleries and dining venues at Verudela shopping avenue, which connects the newly renovated Park Plaza Histria Pula and Park Plaza Verudela Resort.



ROOM NAME	DIMENSION W X L X H (M)	THEATRE ROOM	BOARD ROOM	U-SHAPE ROOM	CLASS ROOM	CABARET DINNER	DINNER DANCE	RECEP- TION
ULIKA	31.0 x 18.0 x 2.70 - 4.60	700	65	200	350	280	350	-
BIANCHERA	7.0 x 10.0 x 3.6	-	24	-	-	-	-	-
BIANCA ISTRIANA	8.0 x 10.0 x 3.6	80	36	30	40	35	40	-
BELICA	4.0 x 7.0 x 3.6	35	22	20	30	-	-	-
VERUDA	13.79 x 5.8 x 3	70	28	28	30	-	-	-
MARINA	3.65 x 4.2 x 3	-	8	-	-	-	-	-



Verudella 17, Pula, HR-52100

T: +385 (0) 52 590 000 F: +385 (0) 52 214 175

meetingscroatia@pphe.com

parkplaza.com/histria

- | | | |
|----------------------------|-----------------------|-------------------------|
| 1 PARK PLAZA HISTRIA PULA | 6 RESORT SPLENDID | 11 ARCH OF THE SERGIANS |
| 2 PARK PLAZA VERUDELA PULA | 7 RESORT HORIZONT | 12 FRESH FOOD MARKET |
| 3 PARK PLAZA ARENA PULA | 8 HOTEL RIVIERA | 13 MARINAS |
| 4 HOTEL BRIONI | 9 AMPHITHEATRE | |
| 5 VERUDELA BEACH | 10 TEMPLE OF AUGUSTUS | |

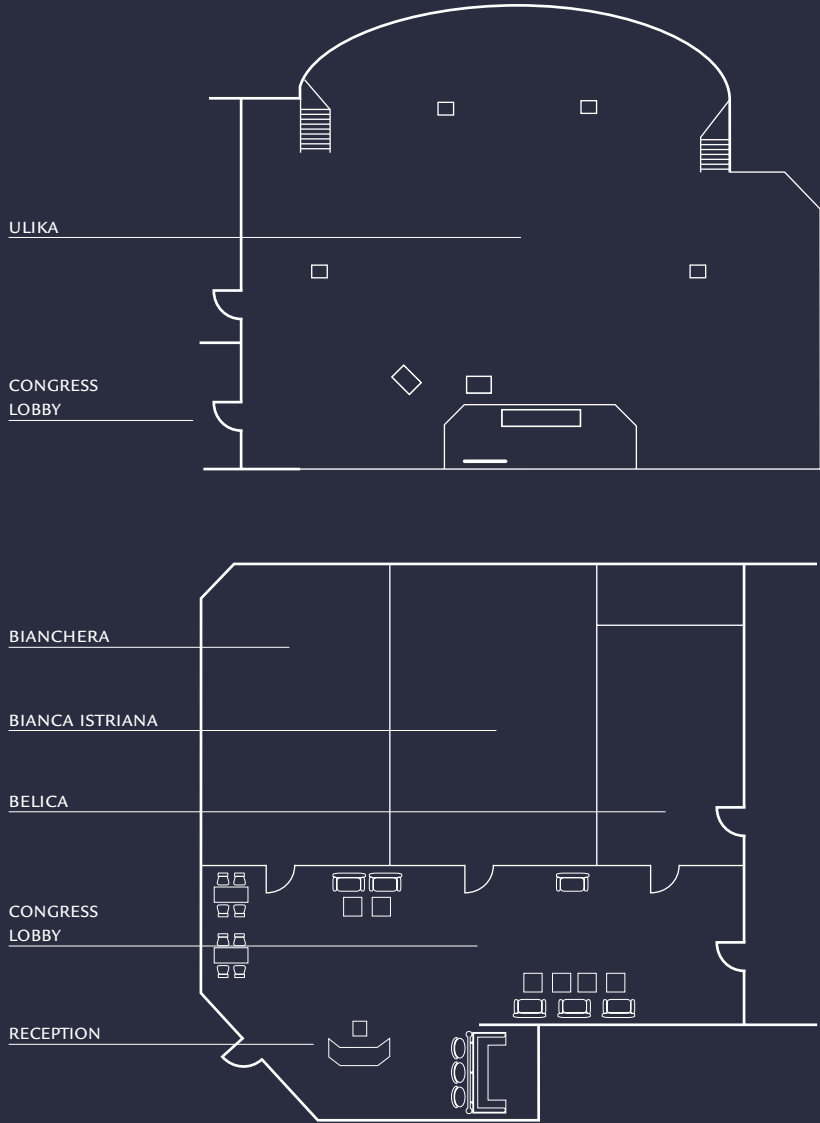



MEZZANINE

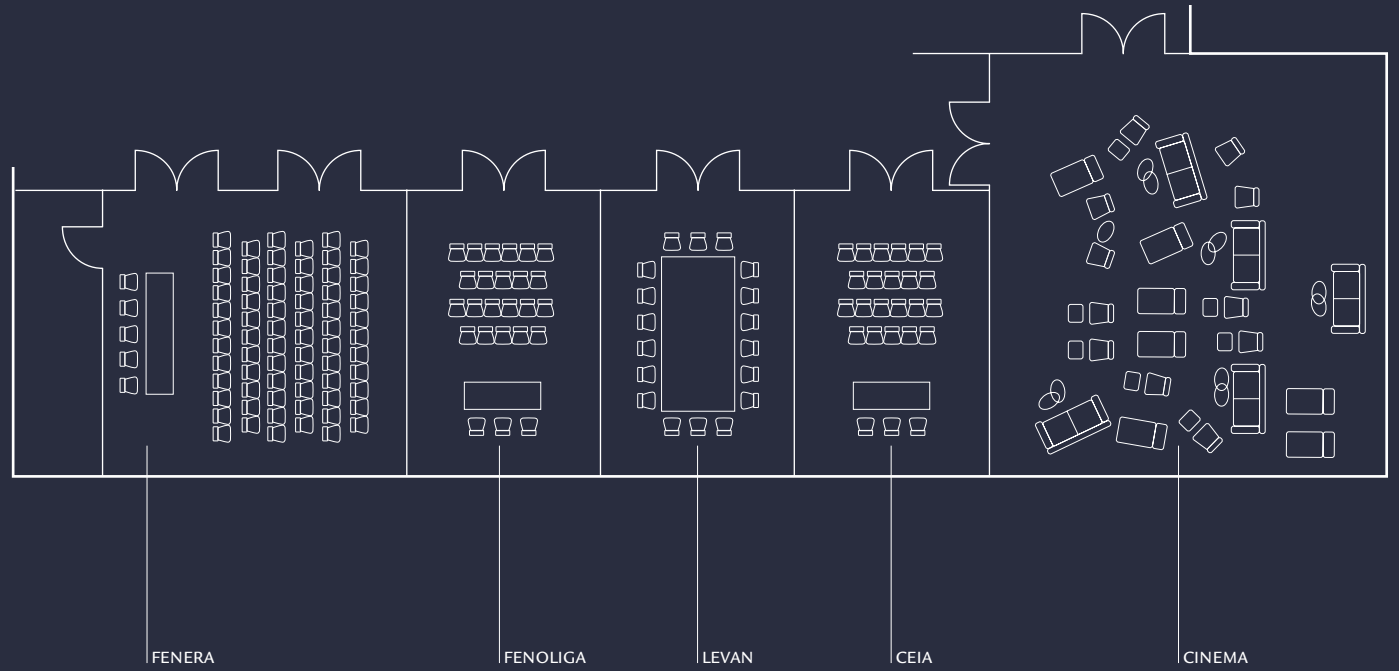

ROOM NAME	DIMENSION W X L X H(M)	THEATRE	BOARD ROOM	U-SHAPE	CLASS ROOM	CABARET DINNER	DINNER DANCE	RECEP- TION
MEZZANINE								
FENERA	9.25 x 9.50 x 3.4	80	-	25	35 - 40	-	-	-
FENOLIGA	8.8 x 6.0 x 3.4	25	-	-	-	-	-	-
LEVAN	8.8 x 6.0 x 3.4	-	25	-	-	-	-	-
CEIA	8.8 x 6.0 x 3.4	25	-	-	-	-	-	-
CINEMA	12.8 x 13.0 x 3.4	120	-	40	60	-	78 - 80	-



PARK PLAZA BELVEDERE MEDULIN

AN ULTRA-MODERN YET WELCOMING VENUE ON THE MEDULIN RIVIERA FOR EXCLUSIVE MEETINGS AND SOCIAL EVENTS WITH UNRIVALLED VIEWS ACROSS THE ADRIATIC

With a majestic setting among century-old pine trees in the heart of an unspoilt archipelago, the newly renovated Park Plaza Belvedere Medulin provides a hi-tech environment for meetings and social gatherings for up to 120 guests. Delegates can also enjoy an array of dining options with stunning sea views and a host of sporting and wellness facilities.

- Four flexible hi-tech meeting rooms
- Exclusive cinema hall for private presentations
- Close to Medulin's lively harbour and the glorious Bijeca beach
- 427 stylised guestrooms, many with private balconies
- Alfresco and à la carte restaurants and a choice of bars
- Outstanding health and wellness centre with three seawater swimming pools, saunas and a fitness and trim room

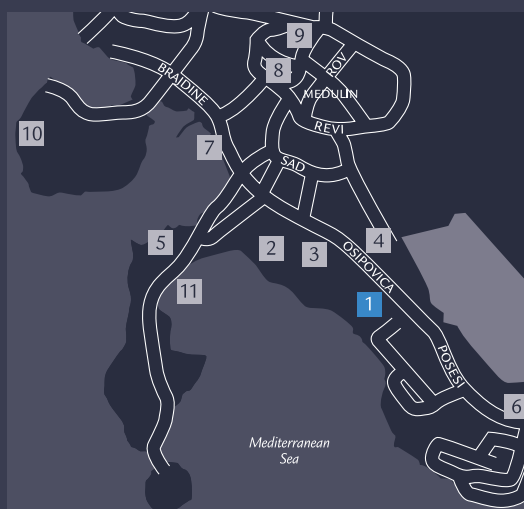
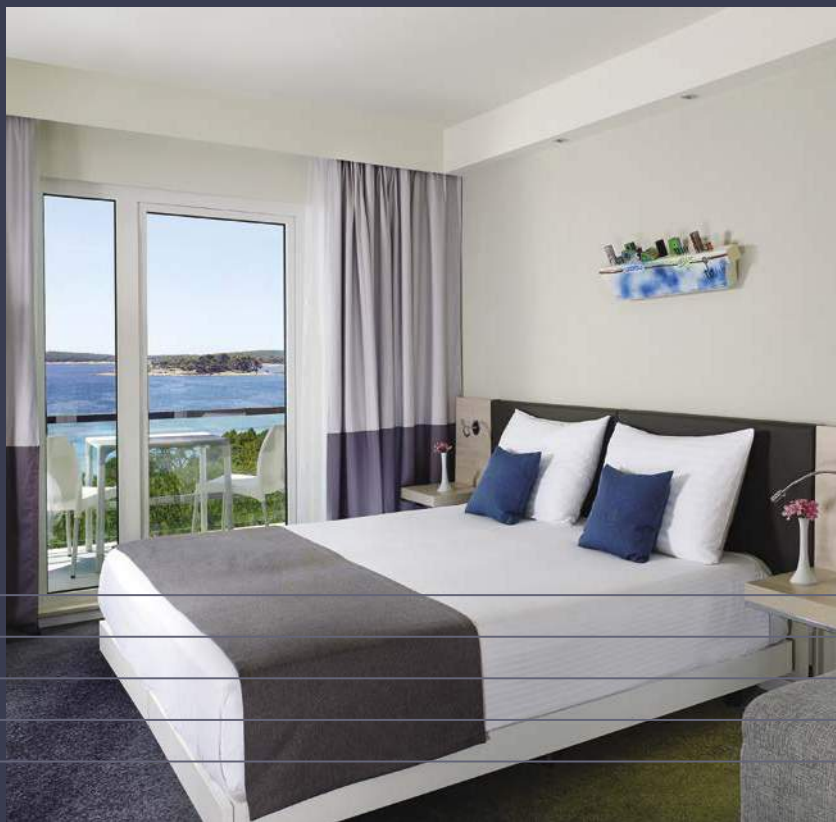

- 1** PARK PLAZA BELVEDERE MEDULIN
- 2** SENSIMAR MEDULIN
- 3** ARENA HOTEL HOLIDAY
- 4** APARTMENT AI PINI
- 5** ARENA MEDULIN CAMPSITE
- 6** ARENA KAŽELA CAMPSITE
- 7** MARINA
- 8** MEDULIN CENTRE
- 9** ST. AGNES CHURCH
- 10** VIŽULA
- 11** BIJECA BEACH



Osipovica 33, Medulin, HR-52203
 T: +385 (0) 52 572 001 F: +385 (0) 52 572 549
 meetingscroatia@pphe.com
 parkplaza.com/belvedere-medulin

“My overall impression of the hotel, accommodation, staff, restaurant and food is indeed very high – and definitely highly recommendable! Accommodation very nice and at high level, staff very kind and helpful and always with a smile, breakfast / lunch / dinner well-prepared, delicious and at very high standard and bar with large selection and bar staff being skilled and cheerful.”

Lars Watson, Kamstrup
Park Plaza Wallstreet Berlin Mitte



GERMANY

GERMANY

As Germany's largest, most dynamic city, Berlin sets a frantic pace. Creativity is everywhere, with new buildings, innovative exhibitions and frenetic nightlife, yet there are also echoes of the city's past. Attractions such as the Brandenburg Gate and the Tiergarten adorn the Mitte district, along with the magnificent art museums of the Kulturforum and the impressive modern skyscrapers of the Potsdamer Platz.

Sitting among gentle hills, the city of Trier boasts the premier collection of Roman remains in Northern Europe. Yet the city is also contemporary and cosmopolitan, with extensive vineyards and a large student population often frequenting the Hauptmarkt which has served as Trier's marketplace since medieval times. With its proximity to Luxembourg and France Trier has a pleasantly relaxed feel, with historical sites such as the 11th-century St Peter's Cathedral, the Porta Nigra and the Kaiserthermen emphasising the city's elaborate history spanning 2,000 years.



PARK PLAZA BERLIN KUDAMM

A CONTEMPORARY EVENTS VENUE WITH
A CHOICE OF CUSTOMISABLE MEETING ROOMS
IN THE HEART OF VIBRANT BERLIN.

Close to Berlin's thriving city centre, Park Plaza Berlin Kudamm offers flexible space for between four and 100 delegates. The hotel is ideal for corporate meetings, functions and private parties with convenient access to Berlin's commercial districts and transport network.

- Charming Garden Salon for private dining for up to 80 guests
- Natural daylight and modern audiovisual systems
- On-site parking
- Germany's key motorway network nearby and Berlin Tegel Airport only 20 minutes away
- 133 contemporary double rooms and Executive Rooms with a courtyard view
- Bar Vostell for cocktails and snacks and the Garden Terrace for al-fresco dining

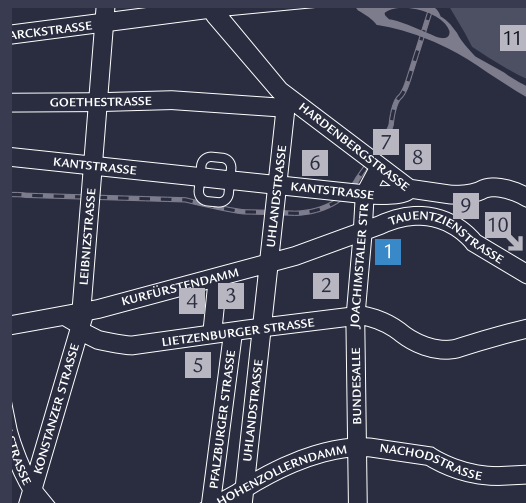

Joachimstaler Strasse 28-29, 10719 Berlin

T: +49 (0) 30 88447 0 F: +49 (0) 30 88447 700

ppbkconf@pphe.com

parkplaza.com/kudamm

- | | | |
|--|--------------------------------------|----------------------|
| 1 PARK PLAZA
BERLIN KUDAMM | 6 THEATER DES WESTENS | 11 TIERGÄRTEN |
| 2 KÄTHE KOLLWITZ
MUSEUM | 7 TRAIN STATION | |
| 3 THE STORY OF BERLIN
MUSEUM | 8 BERLIN ZOOLOGICAL
GARDEN | |
| 4 KURFÜRSTENDAMM
(MAIN SHOPPING SREET) | 9 MEMORIAL CHURCH | |
| 5 ART OTEL
BERLIN KUDAMM | 10 KADEWE | |

ROOM NAME	DIMENSION W X L X H(M)	THEATRE ROOM	BOARD ROOM	U-SHAPE ROOM	CLASS ROOM	CABARET DINNER ROOM	DINNER DANCE	RECEPTION
PARK SUITE I	5.5 X 10.5 X 3.0	40	24	20	30	-	-	40
BREAKFAST ROOM	5.5 X 3.4 X 3.0	-	8	-	-	-	-	-



PARK SUITE 1

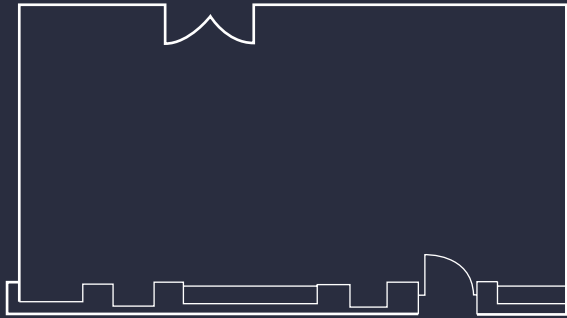

BREAKFAST ROOM

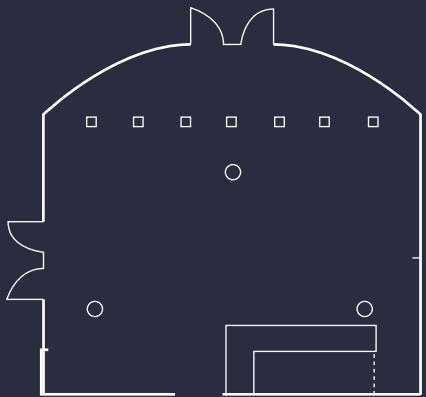

PARK SUITE 2





GROUND FLOOR

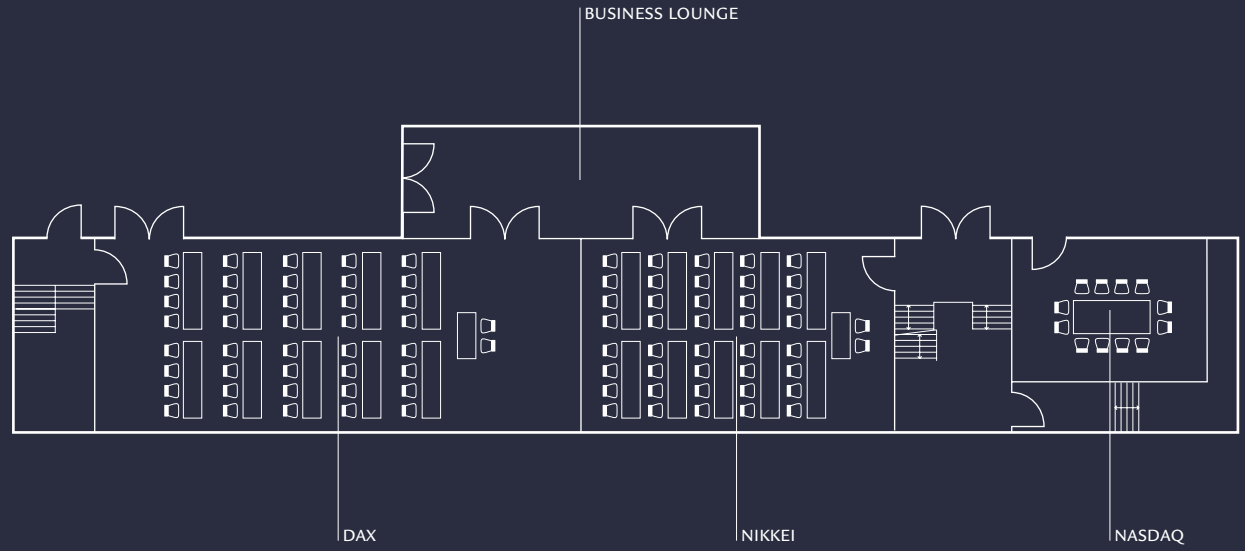

4TH FLOOR

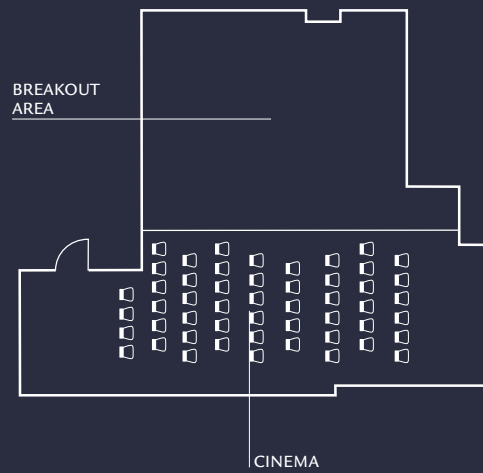

TOP FLOOR

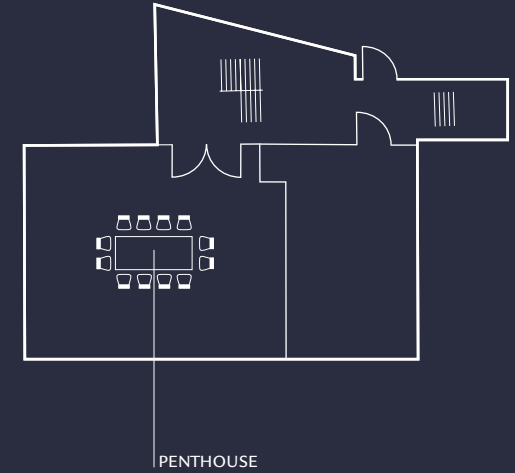

These layouts are examples only and will be adapted according to your request

ROOM NAME	DIMENSION W X L X H(M)	THEATRE	BOARD ROOM	U-SHAPE	CLASS ROOM	CABARET DINNER	BAN- QUET	RECEP- TION
GROUND FLOOR								
NASDAQ	7.0 x 4.0 x 3.4	-	12	-	-	-	-	-
NIKKEI	12.0 x 5.0 x 3.4	40	26	26	26	-	24	40
DAX	18.0 x 5.0 x 3.4	70	40	40	50	-	40	70
NIKKEI & DAX	30.0 x 5.0 x 3.4	140	80	60	80	-	64	150
AUDITORIUM	15.0 x 5.0 x 3.2	50	-	-	-	-	-	-
3RD FLOOR								
SUITE 334	3.5 x 4.5 x 3.2	-	8	-	-	-	-	-
4TH FLOOR								
SUITE 434	3.5 x 4.5 x 3.2	-	8	-	-	-	-	-
TOP FLOOR								
PENTHOUSE	7.0 x 6.0 x 3.6	25	16	16	16	-	-	25



PARK PLAZA WALLSTREET BERLIN MITTE

A QUIRKY AND CONTEMPORARY MEETINGS VENUE IN THE HEART OF BERLIN, WITH STATE-OF-THE-ART AUDIOVISUAL TECHNOLOGY, AIR-CONDITIONING AND NATURAL DAYLIGHT THROUGHOUT.

Located near the Potsdamer Platz, Brandenburger Gate and Alexanderplatz, Park Plaza Wallstreet Berlin Mitte offers a choice of two function rooms combinable for up to 140 delegates, an exclusive cinema and five event rooms which are perfect for board meetings and private gatherings.

- Seven function rooms totalling 295m²
- Impressive penthouse conference room with panoramic Berlin views
- Two intimate suites for board meetings
- Private cinema for up to 50 guests
- Private on-site parking
- Close to key transport links in Berlin city centre
- 167 contemporary and fully equipped guestrooms and suites
- Varied food and drink menus at Light Lounge and bar Rule 404
- Modern fitness centre and sauna

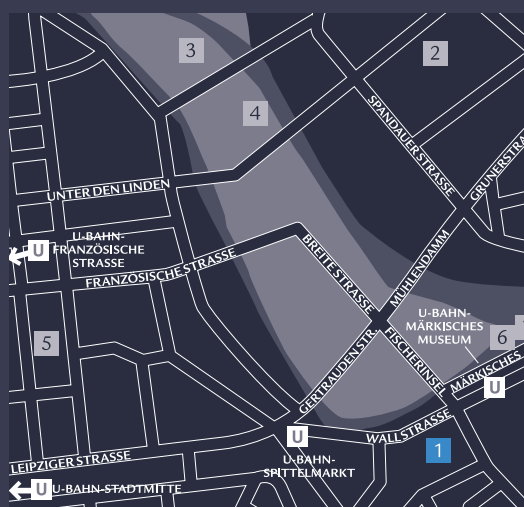

- 1 PARK PLAZA WALLSTREET BERLIN MITTE
- 2 ALEXANDERPLATZ
- 3 MUSEUMSINSEL
- 4 BERLINER DOM
- 5 GENDARMENMARKT
- 6 art'otel berlin mitte
- 7 ERMELERHAUS IM ART'OTEL BERLIN MITTE



Wallstrasse 23-24, 10179 Berlin

T: +49 (0) 30 847 117 0 F: +49 (0) 30 847 117 777

ppwbconf@pphe.com

parkplaza.com/wallstreet

PARK PLAZA NUREMBERG

A CUTTING-EDGE EVENTS VENUE CLOSE TO THE HISTORIC OLD TOWN IN BAVARIA'S SECOND-LARGEST CITY

Formerly the Bavarian American Hotel, the Park Plaza Nuremberg is the city's most impressive conference and meetings venue, just minutes from the Old Town and NürnbergMesse. Perfect for small meetings and social events, the hotel offers flexible meeting space for up to 80 delegates.

- Seven contemporary meeting rooms totalling 287m²
- Videoconferencing, individual air-conditioning, audiovisual systems and bespoke lighting control
- Opposite the main station and convenient for Germany's A3, A9 and A6 motorways and the international airport
- 177 design-led Superior Rooms, Executive Rooms, and spacious suites
- Ultra-modern fitness centre with steam room, sauna and gym
- Informal restaurant serving international and local dishes and hotel bar famous for fine wines, local beers and signature cocktails

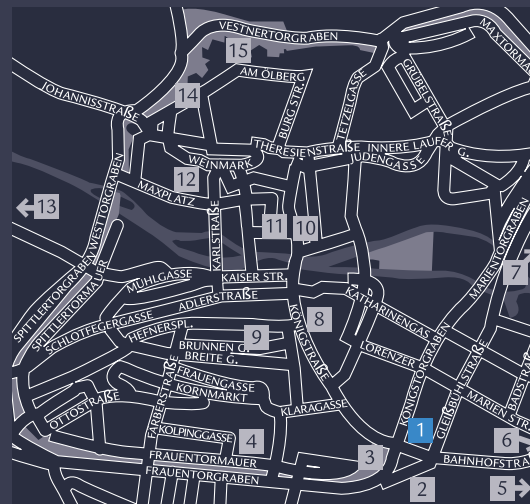

ROOM NAME	DIMENSION W X L X H (M)	THEATRE	BOARD ROOM	U-SHAPE ROOM	CLASS ROOM	CABARET DINNER	DINNER DANCE	RECEPTION
PARK SUITES								
PARK SUITE 1	3.57 x 6.81 x 3.3	32	16	17	-	-	-	28
PARK SUITE 2	3.79 x 6.81 x 3.34	32	16	17	-	-	-	28
PARK SUITE 1+2	7.36 x 6.81 x 3.3	64	32	25	-	-	-	64
PLAZA SUITES								
PLAZA SUITE 1	3.64 x 6.76 x 3.0	16	12	15	-	-	-	22
PLAZA SUITE 2	3.65 x 6.76 x 3.0	16	12	15	-	-	-	25
PLAZA SUITE 3	3.2 x 6.76 x 3.0	12	12	10	-	-	-	20
PLAZA SUITE 4	5.24 x 9.08 x 3.0	35	20	20	-	-	-	40
PLAZA SUITE 5	5.25 x 9.08 x 3.0	35	20	20	-	-	-	40
PLAZA SUITE 4 & 5	10.49 x 9.08 x 3.0	70	32	27	-	-	-	80



Bahnhofstraße 5, 90402 Nuremberg

T: +49 (0)911 21 555 0

ppnuconf@pphe.com

parkplaza.com/nuremberg

- | | | |
|--|---|-------------------------------------|
| 1 PARK PLAZA NUREMBERG | 6 DOCUMENTATION CENTRE NAZI PARTY RALLY GROUND | 11 BEAUTIFUL FOUNTAIN |
| 2 CENTRAL STATION | 7 NUREMBERG ZOO | 12 TOY MUSEUM |
| 3 CRAFTMEN'S COURTYARD AT KÖNIGSTOR TOWER | 8 ST. LAWRENCE CHURCH | 13 MEMORIUM NUREMBERG TRIALS |
| 4 GERMANIC NATIONAL MUSEUM | 9 CITY CENTRE | 14 ALBRECHT DÜRER'S HOUSE |
| 5 TRADE FAIR GROUNDS | 10 CHURCH OF OUR LADY & THE HAUPTMARKT | 15 NUREMBERG CASTLE |

GROUND FLOOR

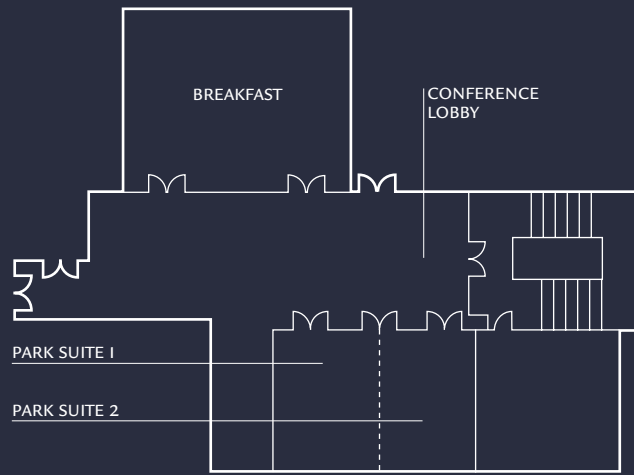

LOWER GROUND FLOOR

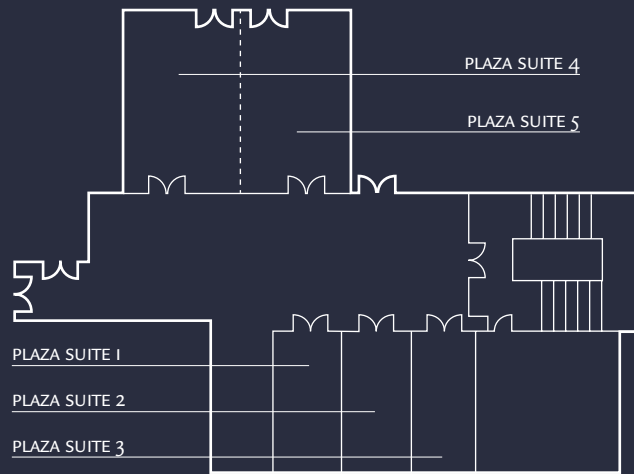



WING A

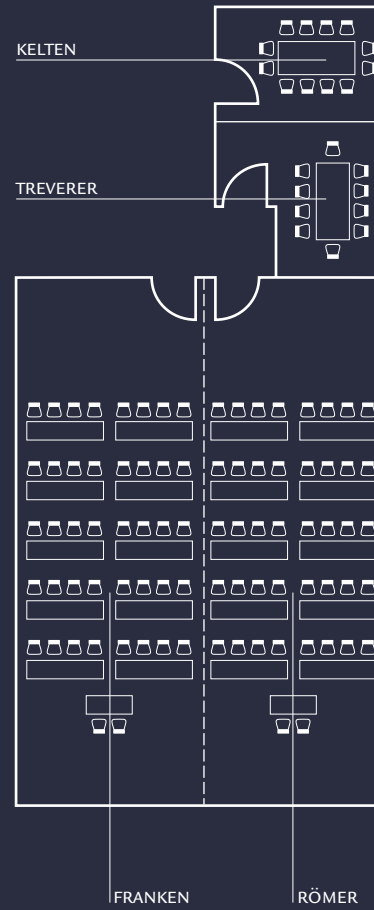

WING B

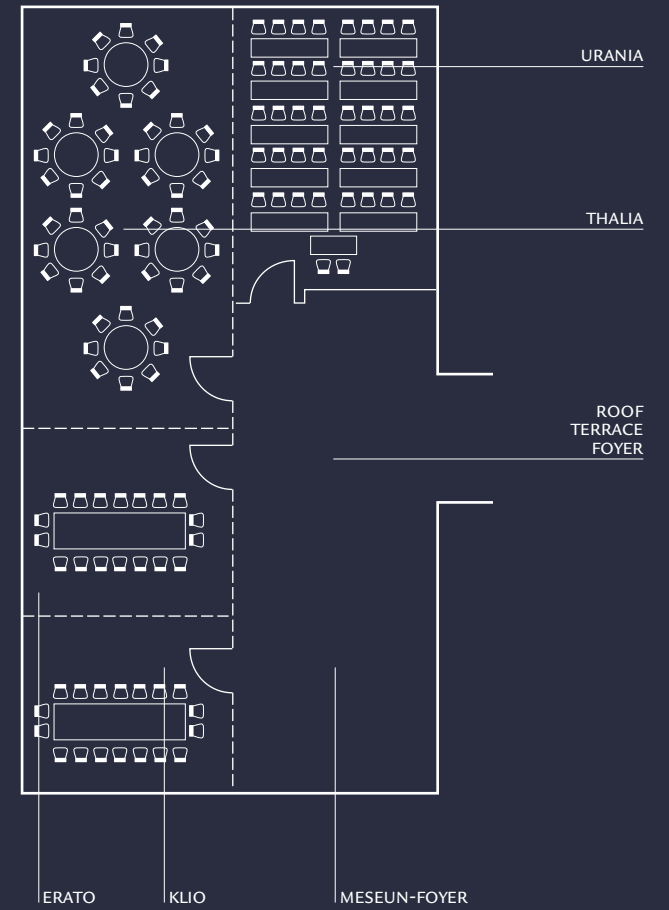

These layouts are examples only and will be adapted according to your request

ROOM NAME	DIMENSION W X L X H(M)	THEATRE ROOM	BOARD ROOM	U-SHAPE	CLASS ROOM	CABARET DINNER	BAN-QUET	RECEPTION
WING A								
KELTEN	6,5 x 4,3 x 2,9	20	12	-	12	-	-	-
TREVERER	5,7 x 4,7 x 2,9	24	12	-	16	-	-	-
RÖMER	10,4 x 7,0 x 3,0	60	28	24	40	-	30	-
FRANKEN	11,0 x 6,7 x 3,0	60	28	24	40	-	30	-
RÖMER & FRANKEN	11,0 x 13,7 x 3,0	120	45	40	90	-	80	-
WING B								
KLIO	7,7 x 7,4 x 2,9	32	20	15	28	-	-	-
ERATO	7,9 x 6,2 x 2,9	32	20	15	28	-	-	-
URANIA	10,4 x 7,7 x 2,9	48	28	22	40	-	35	-
THALIA	11,3 x 7,9 x 2,9	80	36	30	68	-	50	-
KLIO & ERATO	15,6 x 7,4 x 2,9	64	36	30	56	-	50	-
KLIO, ERATO & THALIA	26,9 x 7,9 x 2,9	168	-	-	136	-	120	-
KLIO, ERATO, THALIA & URANIA	-	216	-	-	176	-	180	-
ERATO & THALIA	19,0 x 7,9 x 2,9	128	50	44	104	-	80	-
ERATO, THALIA & URANIA	-	160	-	-	136	-	130	-
THALIA & URANIA	-	128	-	-	108	-	100	-



PARK PLAZA TRIER

EXTENSIVE MEETING AND PRIVATE CELEBRATING FACILITIES FOR UP TO 200 GUESTS IN THE CITY CENTRE JUST 30KM FROM LUXEMBOURG AIRPORT.

Located close to Porta Nigra in central Trier, Park Plaza Trier boasts eight conference rooms, each with natural daylight, for up to 200 delegates. All rooms are air-conditioned and feature state-of-the-art audio-visual technology, while the roof terrace is ideal for special occasions.

- Eight partially combinable meeting rooms totalling 700m²
- Roof terrace with unique views over Trier
- On-site underground car park
- Close to the main commercial district and famous Trierer Dom in Germany's oldest city
- 150 spacious guestrooms and suites
- The restaurant "Plaza Grill" serves grill specialities for meat lovers as well as for vegetarians
- Relaxing lounge bar for pre- and after-dinner cocktails
- Roman health club with sauna, steam bath and massage

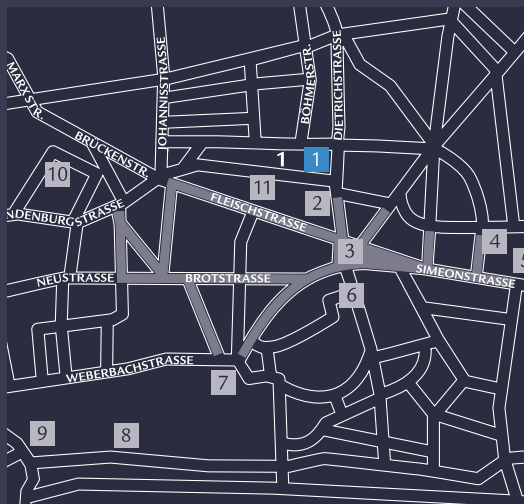

- 1 PARK PLAZA TRIER
- 2 FRANKENTURM
- 3 HAUPTMARKT
- 4 TOURIST OFFICE
- 5 PORTA NIGRA
- 6 DOM & LIEBFRAUENKIRCHE
- 7 KONSTANTIN BASILIKA
- 8 RHEINISCHES LANDESMUSEUM
- 9 KAISERTHERMEN
- 10 THEATRE
- 11 SHOPPING MALL 'TRIER GALERIE'
- PEDESTRIAN ZONE



Nikolaus Koch Platz 1, Trier 54290

T: +49 (0) 651 9993 0 F: +49 (0) 651 9993 555

bankett@parkplaza-trier.de

parkplaza.com/trier

"I find the booking process very straight forward once I have sent over my enquiry they always come back to me if not straight away then within 24 hours.

I find this one of the easiest properties to deal with and the staff are always very helpful and friendly which makes my life much easier!"

Angelina Fairgrieve, The Travel Company Edinburgh
Park Plaza Amsterdam Airport



THE NETHERLANDS

THE NETHERLANDS

Rich in cultural heritage, The Netherlands has been home to many of history's most famous names in the worlds of art, literature, philosophy and science. With magnificent 17th and 18th century merchants' houses flanking its world-famous canals, its capital Amsterdam boasts Europe's largest intact historical city centre. Its narrow streets house delightful shops, cafés and eateries, while a variety of fascinating museums and galleries showcase some of the world's finest art and culture.

Eindhoven, a respected industrial centre and technology hub, has the Philips brand coursing through its veins, while the Van Abbe Museum shows works by Picasso, Chagall, Kandinsky and Mondriaan. Utrecht, meanwhile, offers an unparalleled vitality. With a small medieval city centre boasting world-class festivals, modern architecture, trendy shops and interesting museums alongside a choice of friendly alfresco cafés and restaurants.



PARK PLAZA VICTORIA AMSTERDAM

A CENTRAL AMSTERDAM MEETINGS VENUE RENOWNED FOR OUTSTANDING FACILITIES AND EXCEPTIONAL LEVELS OF SERVICE.

Only 20 minutes from Amsterdam Schiphol Airport and in the heart of the city centre, Park Plaza Victoria Amsterdam is ideal for meetings, events and celebrations. Renowned for friendly staff, the hotel can combine meeting rooms with syndicate suites to host up to 130 delegates.

- Nine flexible meeting rooms with high quality sound system, Samsung LED LCD displays of 82 inch with a resolution of 1920x1080 and barrisol coloured lighting ceilings
- An upscale boardroom, offering natural daylight
- Close to the Amsterdam Stock Exchange and key business parks
- 298 modern hotel rooms, including Superior Rooms, Executive Rooms and spacious suites, many of which have our iconic view of Central Station
- Carstens Amsterdam, a Dutch brasserie focusing on honest food and quality local produce
- VIC's BAR showcases an international cocktail menu and seasonal bites, perfect for hosting private events for up to 130 people
- Fitness centre, Finnish sauna, beauty studio and indoor swimming pool



Damrak 1-5, 1012 LG Amsterdam

T: +31 (0) 20 655 1007 F: +31 (0) 20 658 0585

groupamsterdam@pphe.com

parkplaza.com/victoriaamsterdam

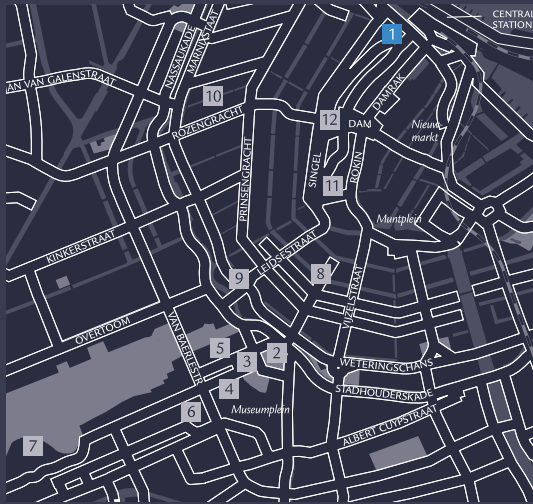

- 1** PARK PLAZA VICTORIA AMSTERDAM
- 2** RIJKSMUSEUM
- 3** STEDELIJK MUSEUM
- 4** VAN GOGH MUSEUM
- 5** P.C. HOOFSTRAAT
- 6** CONCERT HALL
- 7** PARK PLAZA VONDELPARK, AMSTERDAM
- 8** ANTIQUE AND ART GALLERIES
- 9** LEIDSEPLEIN
- 10** ANNE FRANK HOUSE
- 11** KALVERSTAAT (MAIN SHOPPING STREET)
- 12** ROYAL PALACE

ROOM NAME	DIMENSION W X L X H(M)	THEATRE	BOARD ROOM	U-SHAPE	CLASS ROOM	CABARET DINNER	DINNER DANCE	RECEPTION
MEZZANINE FLOOR								
PARK SUITE 1	7.5 x 9.0 x 2.75	50	18	20	24	24	40	-
PARK SUITE 2	7.5 x 9.0 x 2.75	50	18	20	24	24	40	-
PARK SUITES 1+2	15.0 x 9.0 x 2.75	100	36	40	60	60	80	-
PARK SUITE 3	6.5 x 4.0 x 2.75	-	12	-	-	-	-	-
PARK SUITE 4	13.5 x 6.0 x 2.75	70	24	24	30	30	40	-
PRE-FUNCTION AREA								
LOWER GROUND FLOOR								
PLAZA SUITE 1	5.5 x 6.5 x 2.75	35	14	16	18	20	20	-
PLAZA SUITE 2	7.0 x 6.5 x 2.75	45	14	18	24	25	30	-
PLAZA SUITE 3	4.5 x 6.5 x 2.75	30	10	12	12	12	10	-
PLAZA SUITE 4	10.5 x 6.2 x 2.75	60	22	32	42	40	50	-
PLAZA SUITE 5	6.8 x 6.2 x 2.75	40	10	12	12	15	30	-
PLAZA SUITES 1+2	12.5 x 6.5 x 2.75	80	32	32	42	50	50	-
PLAZA SUITES 2+3	11.5 x 6.5 x 2.75	80	22	28	30	30	50	-
PLAZA SUITES 1+2+3	17.5 x 6.5 x 2.75	130	34	40	60	70	80	-
PLAZA SUITES 4+5	17.5 x 6.5 x 2.75	130	40	40	60	60	-	-
PRE-FUNCTION AREA								



LOWER GROUND FLOOR

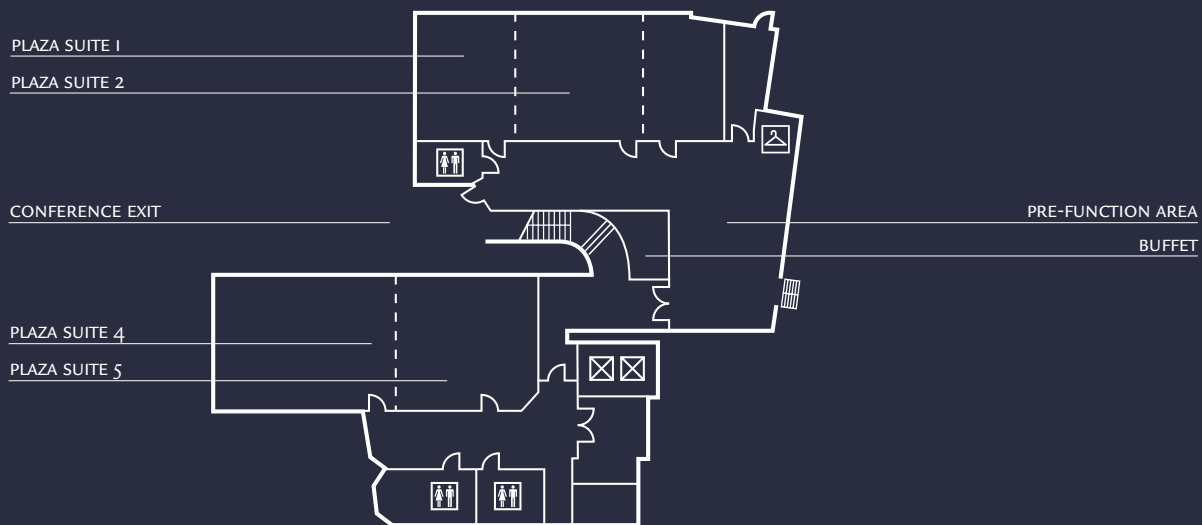

MEZZANINE FLOOR

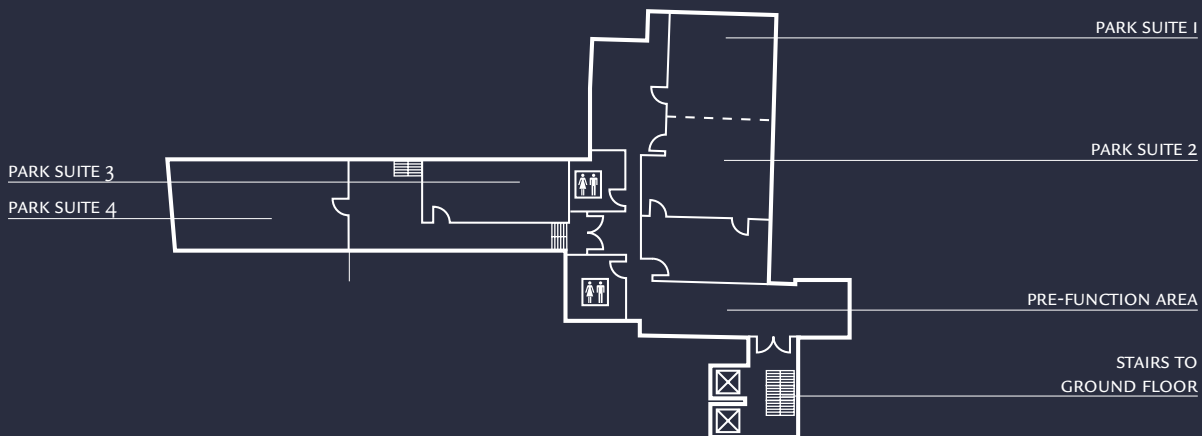

-  Restrooms
-  Cloakroom
-  Lift





VONDELPARK MEETING ROOMS

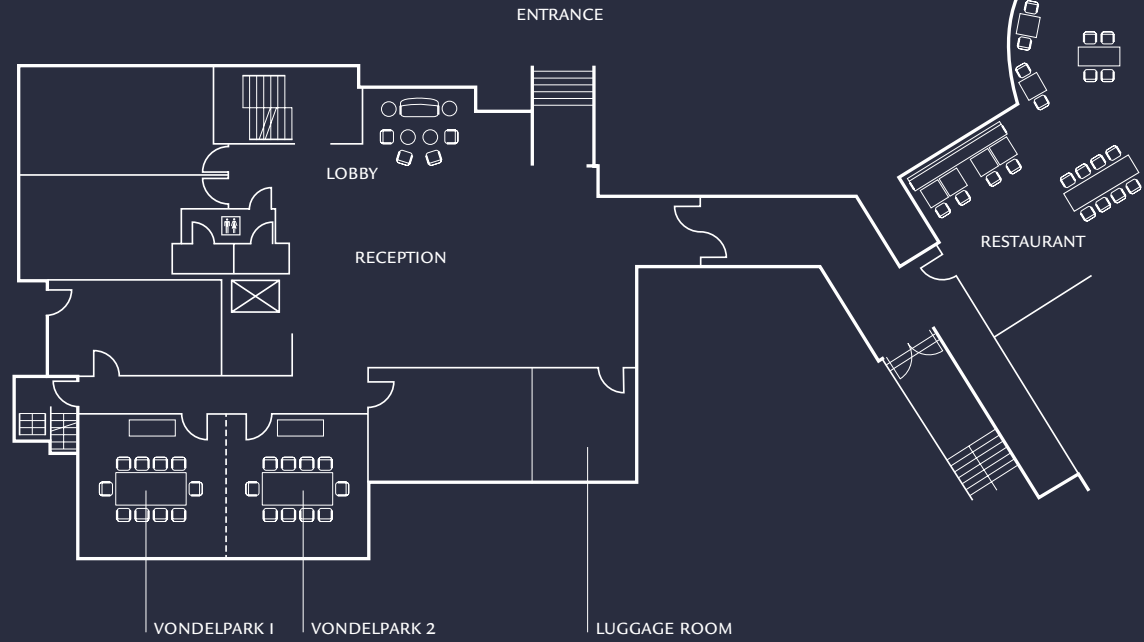

 Restrooms

 Lift

ROOM NAME	DIMENSION W X L X H(M)	THEATRE	BOARD ROOM	U-SHAPE	CLASS ROOM	CABARET DINNER	DINNER DANCE	RECEPTION
VONDELPARK 1	4.7 x 3.8 x 2.4	15	10	-	10	-	10	-
VONDELPARK 2	4.7 x 3.8 x 2.4	15	10	-	10	-	10	-
VONDELPARK 1+2	9.4 x 3.8 x 2.4	30	20	-	20	-	20	-



PARK PLAZA VONDELPARK, AMSTERDAM

OPENING SOON

A STYLISH MEETINGS AND EVENTS VENUE ADJACENT TO ONE OF AMSTERDAM'S MOST DELIGHTFUL PARKS.

Just 15 minutes from Amsterdam Schiphol Airport and overlooking the famous Vondelpark, Park Plaza Vondelpark, Amsterdam is perfect for events for up to 30 guests. The hotel offers a peaceful haven surrounded by prestigious boutiques, fine restaurants and inspiring museums.

- Two meeting rooms for meetings, training days and seminars
- Bespoke menus, staging and decorations available
- Beautiful views across the green and luxurious residential area
- 102 recently renovated guest rooms and suites
- Two one bedroom Junior Suites with private terrace
- On-site restaurant and bar

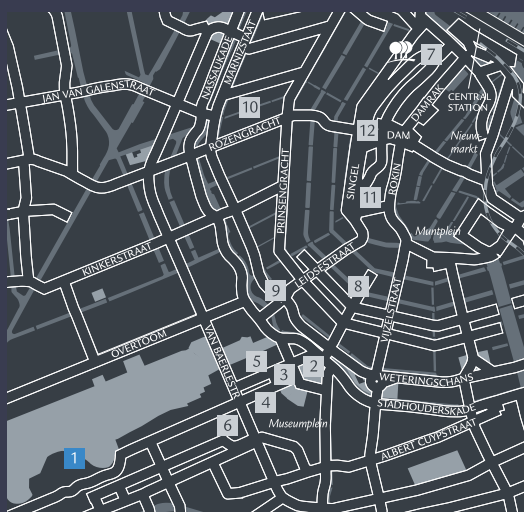

- 1** PARK PLAZA VONDELPARK, AMSTERDAM
- 2** RIJKSMUSEUM
- 3** STEDELIJK MUSEUM
- 4** VAN GOGH MUSEUM
- 5** P.C. HOOFDSTRAAT
- 6** CONCERT HALL
- 7** PARK PLAZA VICTORIA AMSTERDAM
- 8** ANTIQUE AND ART GALLERIES
- 9** LEIDSEPLEIN
- 10** ANNE FRANK HOUSE
- 11** KALVERSTAAT (MAIN SHOPPING STREET)
- 12** ROYAL PALACE



Koningslaan 3, 1075 CZ Amsterdam
 T: +31 (0) 20 664 6111 F: +31 (0) 20 658 0585
 groupamsterdam@pphe.com
 parkplaza.com/vondelpark

PARK PLAZA AMSTERDAM AIRPORT

ONE OF THE LARGEST CONFERENCE AND MEETING VENUES WITHIN THE GREATER AMSTERDAM AREA WITH CAPACITY FOR UP TO 800 DELEGATES.

Park Plaza Amsterdam Airport, a business hotel, close to Amsterdam Schiphol Airport. The flexible meeting space, fully refurbished in September 2018, brings the outdoors indoors, with new interior design reflecting the local surroundings of the hotel. 20 meeting rooms boast natural daylight, an integrated AV system and is ideal for large meetings, conferences and events.

- 20 fully renovated meeting rooms with multiple breakout zones
- Executive boardroom for up to 16 delegates
- Breathtaking 650m² Polder Meeting Room
- Comprehensive on-site parking for up to 250 cars
- Complimentary airport shuttle
- Perfectly located for transport hubs
- 342 spacious Superior and Executive Rooms
- Two restaurants offering a wide choice of international cuisine
- Relaxing lobby bar for pre-dinner cocktails
- Inviting spa and wellness centre
- Delegates can use The Greenery breakout space to relax or brain storm



Melbournstraat 1, 1175 RM Lijnden

T: +31 (0) 20 655 1007 F: +31 (0) 20 658 0585

meetingsamsterdam@pphe.com

parkplaza.com/amsterdamairport

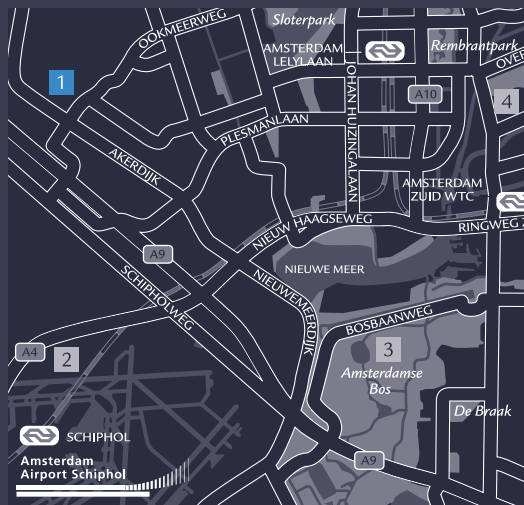

1 PARK PLAZA
AMSTERDAM AIRPORT

2 AMSTERDAM AIRPORT
SCHIPHOL

3 AMSTERDAMSE BOS

4 PARK PLAZA VONDELPARK,
AMSTERDAM

ROOM NAME	DIMENSION W X L X H (M)	THEATRE BOARD ROOM		U-SHAPE ROOM		CLASS CABARET DINNER ROOM		
GROUND FLOOR POLDER MEETING ROOMS								
EXECUTIVE BOARDROOM	9.30 x 6.5 x 4.2	-	16	-	-	-	-	-
POLDER MEETING ROOM 1	7.5 x 15.0 x 3.85	120	34	40	56	48	64	
POLDER MEETING ROOM 2	7.5 x 15.0 x 3.85	120	34	40	56	48	64	
POLDER MEETING ROOM 3	12.0 x 14.7 x 15.0 x 3.85	220	34	48	104	90	120	
POLDER MEETING ROOM 1 + 2	15.0 x 15.0 x 3.85	240	-	48	112	96	128	
POLDER MEETING ROOM 2 + 3	19.5 x 22.2 x 15.0 x 3.85	340	-	56	160	138	184	
POLDER MEETING ROOM 1 + 2 + 3	29.7 x 28.0 x 15 x 3.85	460	-	64	216	186	248	
POLDER MEETING ROOM 1+2+3&FOYER	29.7 x 28 x 24 x 3.85	800	-	-	350	258	344	
2ND FLOOR FIELD MEETING ROOMS								
FIELD MEETING ROOM 1	6.8 x 7.7 x 2.65	68	20	18	36	24	-	
FIELD MEETING ROOM 2	6.8 x 7.7 x 2.65	68	20	18	36	24	-	
FIELD MEETING ROOM 3	6.8 x 7.7 x 2.65	68	20	18	36	24	-	
FIELD MEETING ROOM 4	4.0 x 6.8 x 2.65	30	12	14	16	-	-	
FIELD MEETING ROOM 5	4.5 x 11.5 x 2.65	103	24	24	50	48	-	
FIELD MEETING ROOM 6	5.5 x 7.9 x 2.65	56	20	22	24	18	-	
FIELD MEETING ROOM 7	2.7 x 5.5 x 2.65	-	6	-	-	-	-	
FIELD MEETING ROOM 8	7.0 x 7.1 x 2.65	68	20	18	36	24	-	
FIELD MEETING ROOM 9	7.0 x 7.1 x 2.65	68	20	18	36	24	-	
FIELD MEETING ROOM 10	4.1 x 7.1 x 2.65	30	16	14	16	12	-	
THE GREENERY		16	12	-	12	-	-	
3RD FLOOR SKY MEETING ROOMS								
SKY MEETING ROOM 1	6.8 x 7.7 x 2.65	68	20	18	36	24	-	
SKY MEETING ROOM 2	6.8 x 7.7 x 2.65	68	20	18	36	24	-	
SKY MEETING ROOM 3	12.0 x 14.5 x 2.65	210	32	48	96	72	-	
SKY MEETING ROOM 4	3.9 x 7.7 x 2.65	20	14	-	12	-	-	
SKY MEETING ROOM 5	7.1 x 7.1 x 2.65	68	20	18	36	24	-	
SKY MEETING ROOM 6	7.1 x 11.5 x 2.65	118	26	28	42	42	-	

GROUND FLOOR POLDER MEETING ROOMS

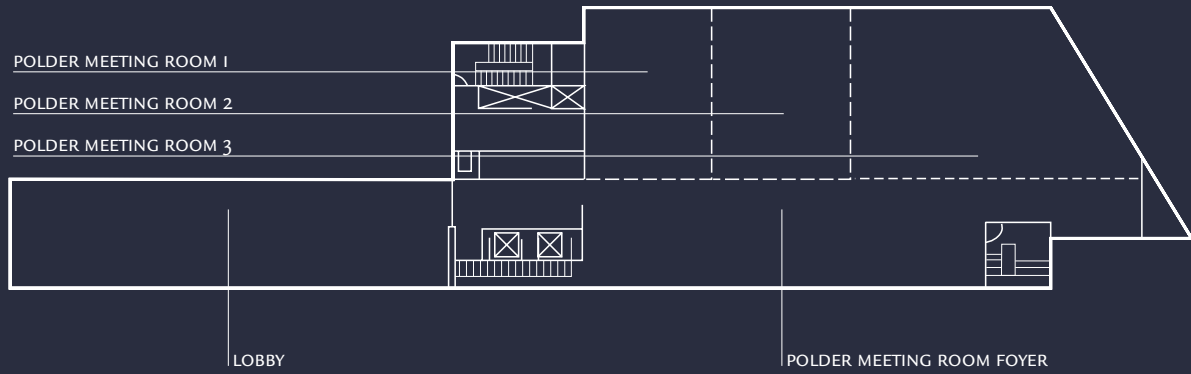

2ND FLOOR FIELD MEETING ROOMS

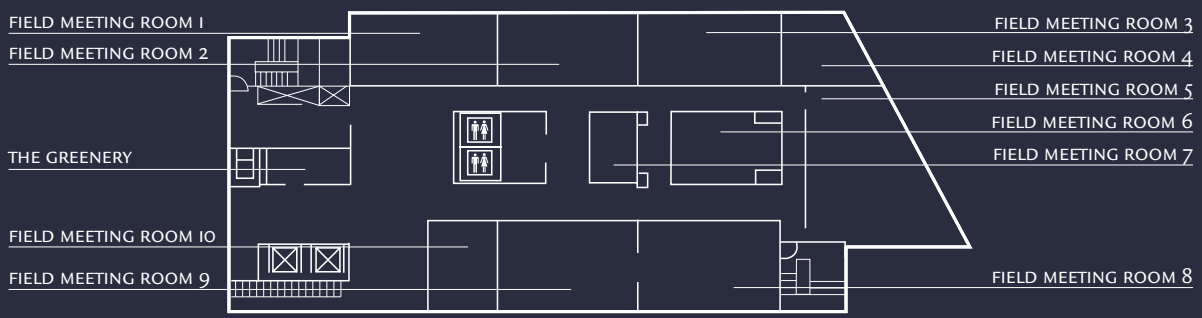

3RD FLOOR SKY MEETING ROOM

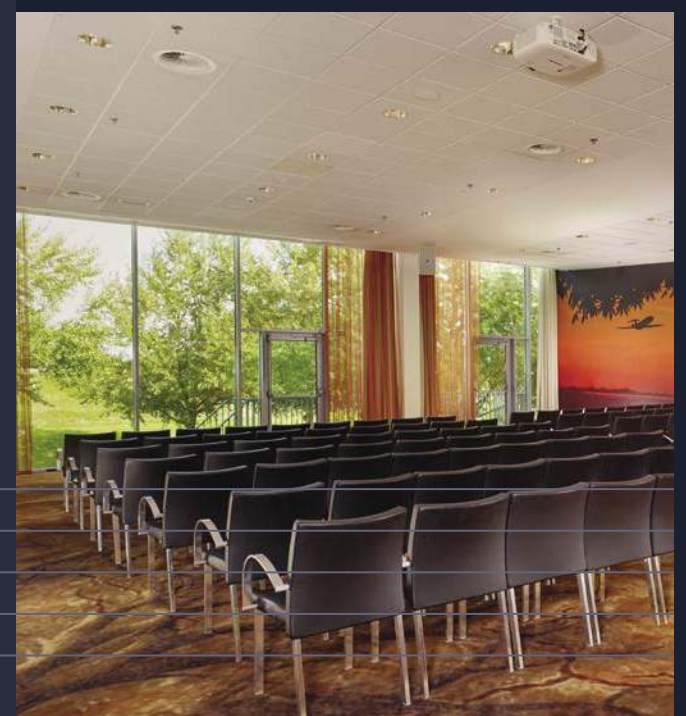
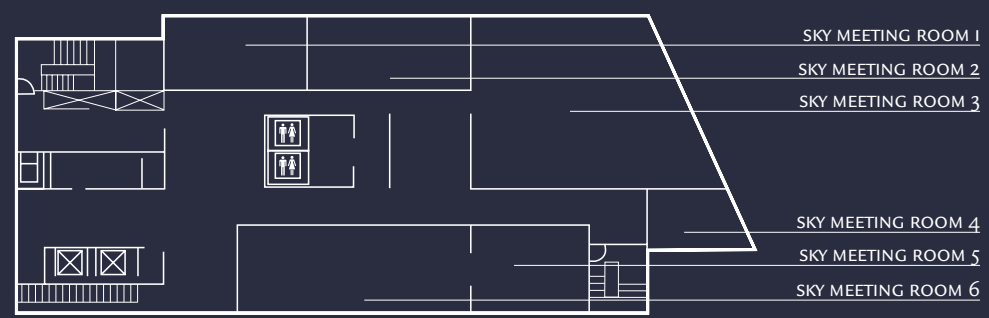

Restrooms
 Lift

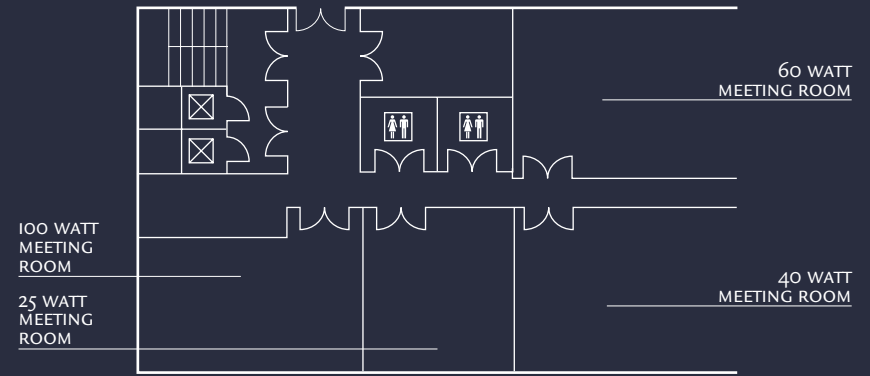
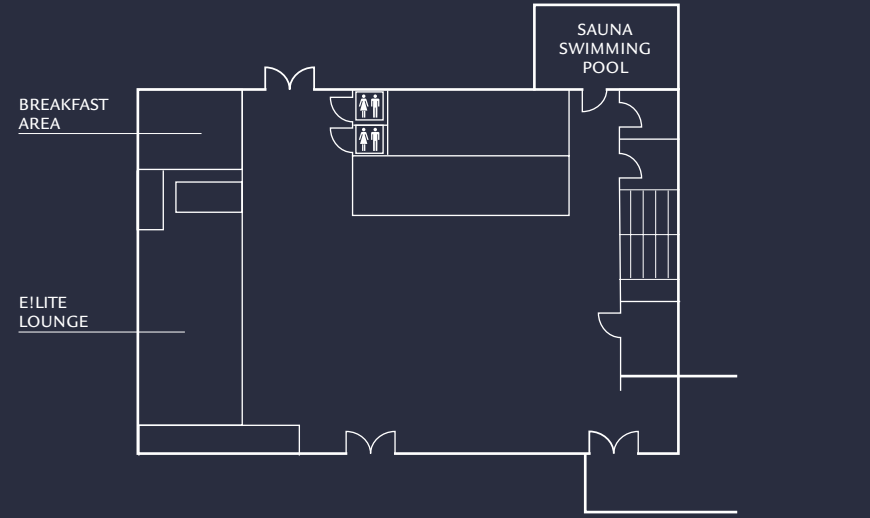

 Restrooms

 Lift

ROOM NAME	DIMENSION W X L X H(M)	THEATRE	BOARD ROOM	U-SHAPE	CLASS ROOM	CABARET DINNER	DINNER DANCE	RECEPTION
CONFERENCE FLOOR								
25 WATT BOARDROOM	8.0 x 7.0 x 3.0	30	20	15	20	25	-	-
40 WATT BOARDROOM	11.0 x 8.0 x 3.0	75	35	30	40	50	-	-
60 WATT BOARDROOM	11.0 x 8.0 x 3.0	75	35	30	40	50	-	-
100 WATT BOARDROOM	10.0 x 7.0 x 3.0	-	20	-	-	-	-	-



PARK PLAZA EINDHOVEN

RENOWNED FOR WORLD-CLASS PERSONAL SERVICE, PARK PLAZA EINDHOVEN IS A LEADING VENUE FOR SMALL MEETINGS, TRAINING SESSIONS AND PRIVATE FUNCTIONS.

Park Plaza Eindhoven offers a fresh setting for meetings, conferences, parties and gala dinners in the heart of the brainport of the Netherlands. Flexible spaces, outstanding dining options and inviting accommodation combined with attentive service to provide the ultimate event venue.

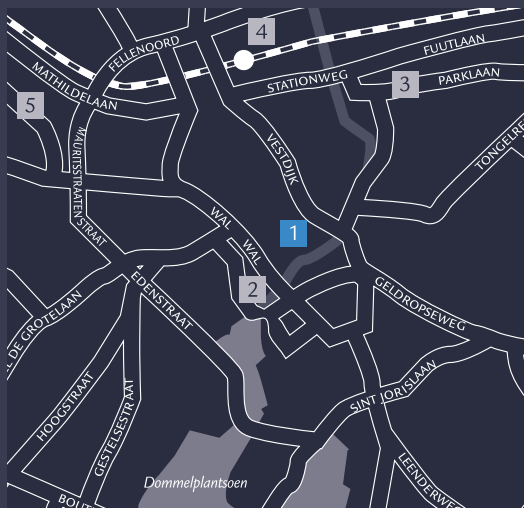

- 1 PARK PLAZA EINDHOVEN
- 2 MODERN ARTS VAN ABBE MUSEUM
- 3 EFFENAAR MUSIC CENTRE & HEUVEL GALERIJ
- 4 CENTRAL STATION
- 5 PSV EINDHOVEN STADIUM

- Three contemporary meeting rooms for up to 75 delegates, all with natural daylight
- 100 Watt Boardroom with interactive smartboard and Bose sound system
- Private on-site parking
- Close to key transport hubs and Eindhoven's major business districts
- 104 Superior Rooms, Executive Rooms and suites featuring a sleek, trendy and fashionable design.
- Elite Lounge serving lunch, dinner, tapas and cocktails
- Three recommended restaurants: Park C (European Food bar), Arigato (Asian Fusion cuisine), Momoyama (Teppanyaki restaurant)
- Health club with indoor swimming pool, fitness area and Finnish saunas



Geldropseweg 17, 5611 SC Eindhoven

T: +31 (0) 40 214 6523 F: +31 (0) 40 212 1555

ppmeetings@pphe.com

parkplaza.com/eindhoven

PARK PLAZA UTRECHT

A STRIKING GLASS-FRONTED MEETINGS VENUE IN CENTRAL UTRECHT CLOSE TO THE JAARBEURS EXHIBITION & CONVENTION CENTRE.

Located close to the city's key transport hubs, Park Plaza Utrecht lends itself to corporate meetings and private entertaining. Light and airy, the hotel's meeting rooms can host up to 120 delegates, while smaller functions can be staged in the exclusive Westpark Boardroom.

- 10 fully renovated meeting rooms on the top floor, each with natural daylight, spectacular views and all reflecting the manifestos of De Stijl, a Dutch artistic movement
- Private dining room for up to 45 guests
- Extensive on-site parking
- 30 minutes from Amsterdam Schiphol Airport
- 120 Guest, Superior and fully renovated Executive Rooms, some with iconic view
- Executive level guests enjoy a luxury bathroom with rain shower, Nespresso machine, bathrobe, slippers and stunning city views
- Plein 50, the hotel's restaurant, bar & brasserie, serves exquisite international dishes
- Modern fitness centre

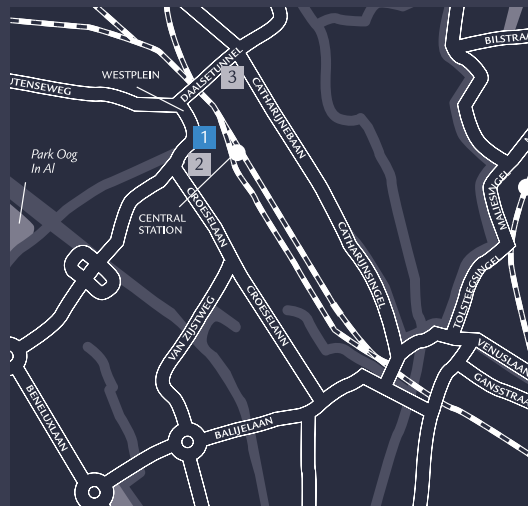

- 1 PARK PLAZA UTRECHT
- 2 THE JAARBEURS EXHIBITION & CONVENTION CENTRE
- 3 HOOG CATHARIJNE SHOPPING CENTRE

ROOM NAME	DIMENSION W X L X H(M)	THEATRE ROOM	BOARD ROOM	U-SHAPE ROOM	CLASS ROOM	CABARET DINNER	DINNER DANCE	RECEPTION
CONFERENCE FLOOR								
PLAZA SUITE 1	7.0 x 7.0 x 2.55	30	22	19	22	28	-	-
PLAZA SUITE 2	7.0 x 7.0 x 2.56	30	22	19	22	28	-	-
PLAZA SUITE 3	10.0 x 7.0 x 2.55	50	32	28	40	45	-	-
PLAZA SUITE 4	10.0 x 7.0 x 2.55	50	26	25	30	45	-	-
PLAZA SUITE 1 & 2	14.0 x 7.0 x 2.55	80	42	35	60	60	-	-
PLAZA SUITE 2 & 3	17.0 x 7.0 x 2.55	100	-	42	77	77	-	-
PLAZA SUITE 1, 2 & 3	24.0 x 7.0 x 2.55	120	-	-	120	100	110	150
PARK SUITE 1	7.0 x 6.0 x 2.55	30	22	19	22	28	-	-
PARK SUITE 2	7.0 x 3.5 x 2.55	-	10	-	-	-	-	-
PARK SUITE 3	7.0 x 6.0 x 2.55	30	22	19	22	28	-	-
PARK SUITE 4	7.0 x 3.5 x 2.55	-	10	-	-	-	-	-
PARK SUITE 5	6.0 x 3.5 x 2.55	-	8	-	-	-	-	-
EXECUTIVE PARK SUITE	7.0 x 3.5 x 2.55	-	10	-	-	-	-	-
PRIVATE DINING ROOM	8.0 x 8.0 x 2.55	30	24	16	18	45	-	-
PRE-FUNCTION AREA								



Westplein 50, 3531 BL Utrecht

T: +31 (0) 30 292 5170 F: +31 (0) 30 292 5199

group utrecht@pphe.com

parkplaza.com/utrecht

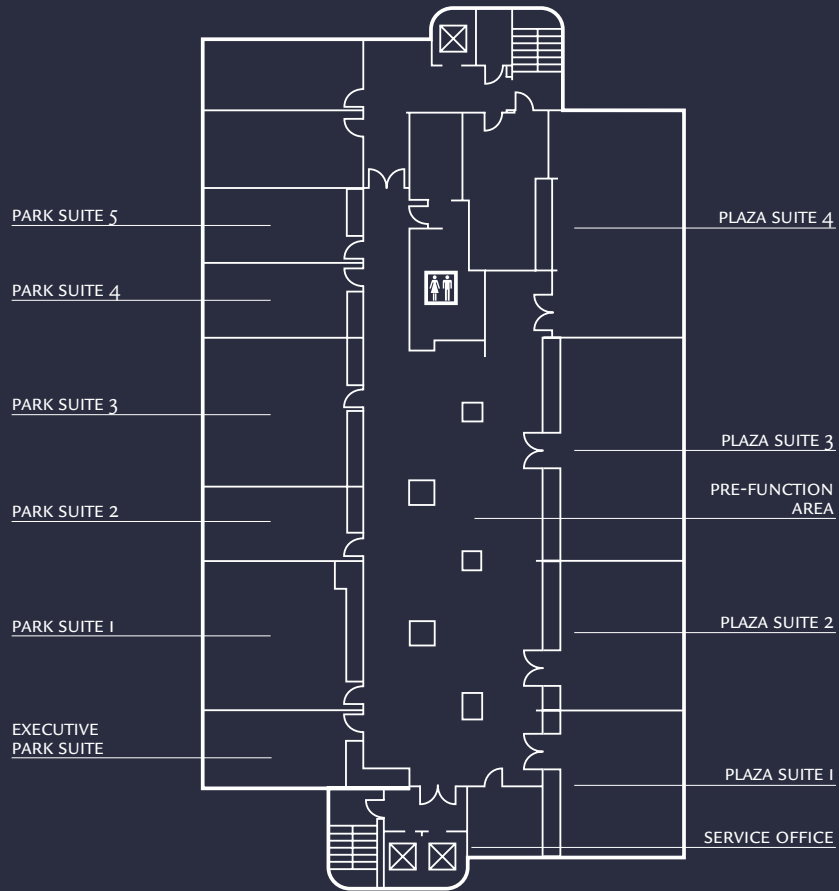

-  Restrooms
-  Cloakroom
-  Lift



“The event was very successful, and it is with great thanks to you and all the staff at the hotel that worked really hard to ensure the event ran smoothly on the day.”

Ed Balls, Labour Party Lunch
Park Plaza Leeds



UNITED KINGDOM

UNITED KINGDOM

Steeped in history and culture, it's no surprise that the United Kingdom is one of the world's leading destinations. Its capital, London, is blessed with historical sites at every turn, from the landmark Houses of Parliament to Buckingham Palace and St Paul's Cathedral. World-class theatre, opera and contemporary music are performed every day, and award-winning restaurants and lively nightclubs attract visitors from the world over.

Cardiff has re-defined itself with developments such as the Millennium Stadium and the Welsh National Assembly and Millennium Centre on the rejuvenated Cardiff Bay waterfront. As Yorkshire's commercial capital, Leeds is capitalising on its Victorian past to create awe-inspiring attractions such as the Royal Armouries that are both contemporary and rich in history. And once known for lace and pharmaceuticals, the city of Nottingham is still associated with the legendary 13th-century outlaw Robin Hood.



aim

An Assurance of Excellence
Making Meetings Better



PARK PLAZA CARDIFF

CONTEMPORARY MEETING SPACE COMBINED WITH EXCEPTIONAL PERSONAL SERVICE AND ATTENTION TO DETAIL IN THE HEART OF THE WELSH CAPITAL.

Park Plaza Cardiff offers flexible meeting and events solutions for up to 150 delegates or 250 guests in the heart of the city centre. Eleven meeting rooms are complemented by art-inspired guestrooms, award-winning cuisine and a two-floor nightclub.

- 11 function suites, most with natural daylight
- Exclusive Kuku Club nightclub for private parties seven days a week
- Licensed for weddings and civil ceremonies
- Close to the Millennium Stadium and Cardiff Castle
- 129 Deluxe guestrooms and Executive rooms with bespoke art
- Laguna Kitchen & Bar for enticing menus focusing on Welsh produce
- Laguna Health & Spa offering eight treatment rooms with gym, jacuzzi, steam room and 20m pool
- All function rooms and guest rooms are fully air-conditioned

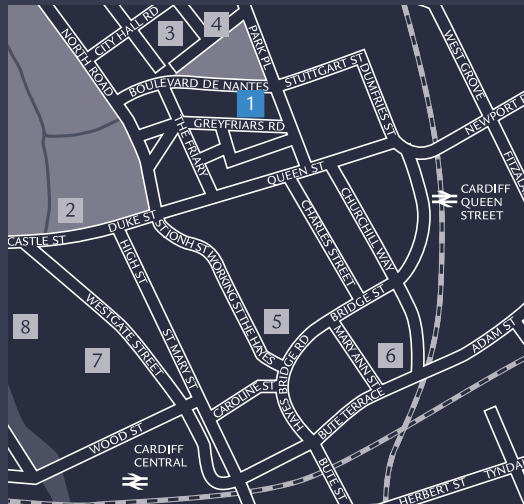

- 1** PARK PLAZA CARDIFF
- 2** CARDIFF CASTLE
- 3** CITY HALL
- 4** NATIONAL MUSEUM & GALLERY OF WALES
- 5** ST DAVID'S HALL
- 6** MOTORPOINT CARDIFF
- 7** PRINCIPALITY STADIUM
- 8** CARDIFF BLUES STADIUM

ROOM NAME	DIMENSION W X L X H(M)	THEATRE	BOARD ROOM	U-SHAPE ROOM	CLASS ROOM	CABARET DINNER	DINNER DANCE	RECEPTION
PARK FLOOR								
PLAZA SUITE	14 x 16 x 3.4	160	-	-	70	80	150	250
PLAZA SUITE 1	14.0 x 8.0 x 3.4	125	-	30	60	48	80	130
PLAZA SUITE 2	11.3 x 7.5 x 3.4	-	-	10	-	-	60	100
PARK SUITE 1	6.4 x 4.0 x 3	20	12	10	15	-	-	-
PARK SUITE 2	6.4 x 4.1 x 3	20	12	10	15	-	-	-
PARK SUITE 3	6.4 x 4.1 x 3	20	12	10	15	-	-	-
PARK SUITE 4	6.4 x 4.0 x 3	20	12	10	15	-	-	-
PARK SUITES 1 & 2	5.4 x 8.1 x 3	50	24	15	30	-	24	50
PARK SUITES 3 & 4	5.4 x 8.1 x 3	50	24	15	30	-	24	50
PARK SUITE 1-3	6.4 x 12.2 x 3	75	36	20	45	-	36	75
PARK SUITE 1-4	6.4 x 16.2 x 3	120	48	28	60	36	48	100
FIRST FLOOR								
CIVIC SUITE 1	8.4 x 3.8 x 2.7	30	20	15	-	-	-	-
CIVIC SUITE 2	8.4 x 3.8 x 2.7	30	20	15	-	-	-	-
CIVIC SUITE 3	8.4 x 3.8 x 2.7	30	20	15	-	-	-	-
CIVIC SUITE 4	8.4 x 3.8 x 2.7	30	20	15	-	-	-	-
CIVIC SUITE 5	13.0 x 3.94 x 2.7	60	30	25	18	20	30	50
GROUND FLOOR								
KUKU LOUNGE	16.5 x 5.0 x 3.5	-	-	-	-	-	-	180

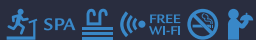

Greyfriars Road, Cardiff CF10 3AL

T: +44 (0) 2920 111 111 F: +44 (0) 2920 111 112

reception@parkplazacardiff.com

parkplaza.com/cardiff

PARK FLOOR

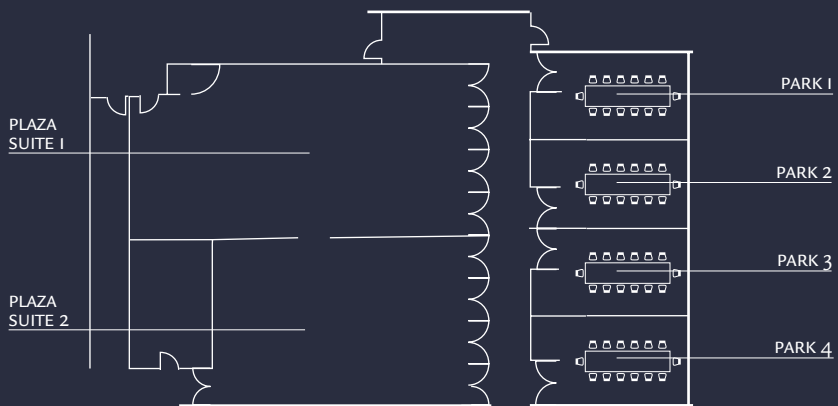

FIRST FLOOR

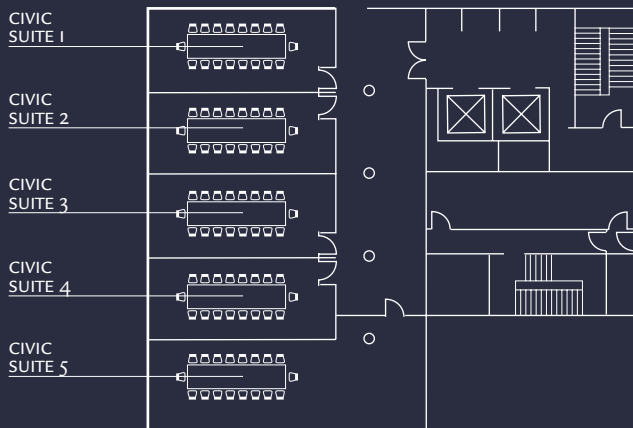

☒ Lift



PARK FLOOR

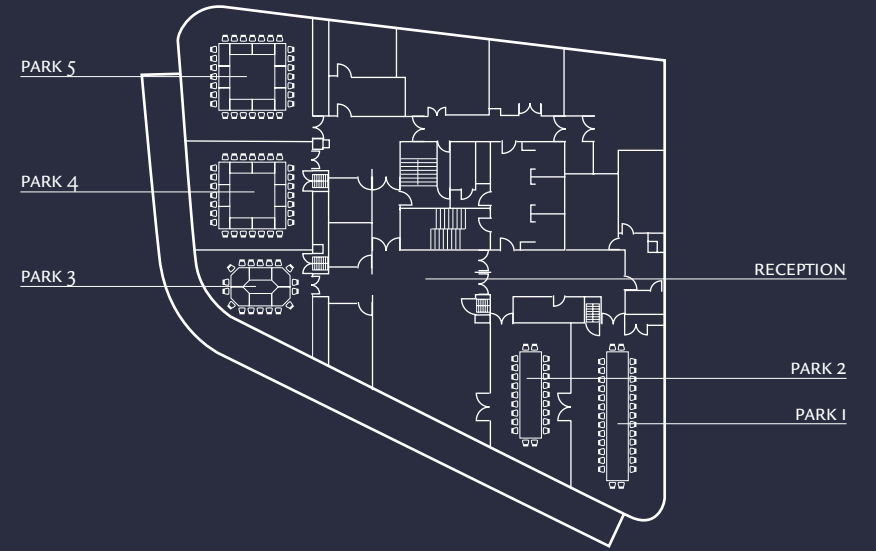

PLAZA FLOOR

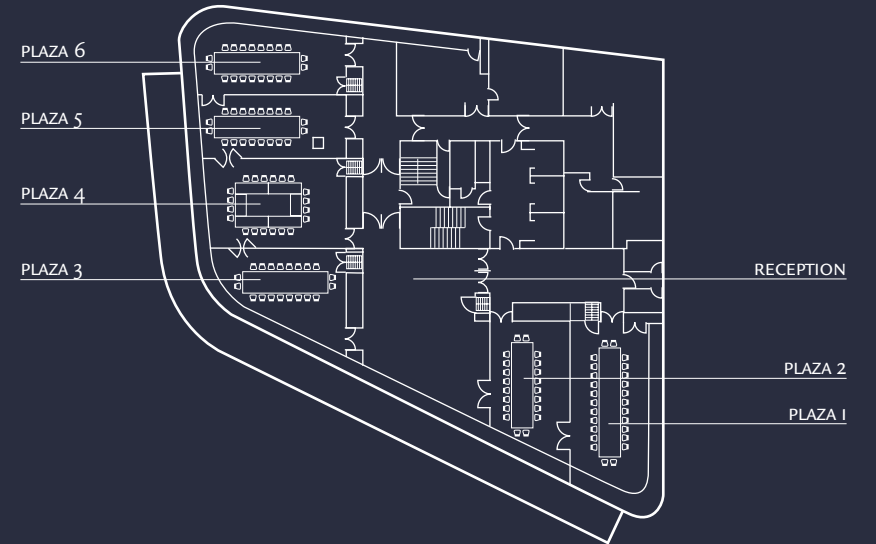

PARK PLAZA LEEDS

CAPACITY FOR UP TO 350 DELEGATES ACROSS TWO DEDICATED MEETINGS AND EVENTS FLOORS OPPOSITE THE CITY'S TRAIN STATION.

From dinners to board meetings and training sessions overlooking City Square, Park Plaza Leeds offers a flexible events solution close to the north of the UK's airports, motorways and railway network. With 11 meeting rooms, space can be configured for meetings, corporate events and social gatherings.

- Two meetings and events floors and four purpose-built suites
- 11 meeting rooms with natural daylight and wraparound views
- Four Suites including a Penthouse Apartment with views of the Leeds skyline
- Licensed for weddings and civil ceremonies
- 187 contemporary guestrooms and suites
- Spacious Executive Rooms and Executive Lounge
- Award-winning Chino Latino® Pan-Asian Restaurant & Bar
- Scene Lobby Bar overlooking City Square
- Fully equipped fitness centre

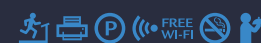

Boar Lane, City Square, Leeds LS1 5NS

T: +44 (0) 333 400 6144 F: +44 (0) 333 400 6145

pplconf@pphe.com

parkplaza.com/leeds

ROOM NAME	DIMENSION W X L X H(M)	THEATRE	BOARD ROOM	U-SHAPE	CLASS ROOM	CABARET DINNER	DINNER DANCE	RECEP- TION
PARK FLOOR								
PARK 1	6.3 x 10.9 x 2.2	70	30	27	30	35	50	40
PARK 2	5.7 x 9.8 x 2.2	50	20	16	16	24	40	-
PARK 3	7.3 x 7.75 x 2.2	24	12	12	12	21	20	-
PARK 4	7.2 x 7.75 x 2.2	60	20	18	24	32	40	-
PARK 5	8.3 x 8.4 x 2.2	70	22	22	32	35	50	-
PARK 1-2	12.0 x 10.38 x 2.2	120	38	34	40	64	100	80
PARK 3-4	14.5 x 7.75 x 2.2	80	30	28	34	56	90	70
PARK 3-5	8 x 22.8 x 2.2	200	80	83	70	120	200	176
PARK 4-5	15.5 x 8.1 x 2.2	120	40	38	54	72	120	80
PARK FLOOR	-	-	-	-	-	-	-	350
PLAZA FLOOR								
PLAZA 1	5.6 x 9.7 x 2.2	60	24	25	30	32	50	30
PLAZA 2	5.3 x 7.1 x 2.2	40	20	20	14	24	20	-
PLAZA 3	7.2 x 9.15 x 2.2	22	12	10	10	16	20	-
PLAZA 4	5.65 x 9.6 x 2.2	50	16	18	22	21	40	-
PLAZA 5	4.3 x 10.0 x 2.2	45	16	10	12	21	30	-
PLAZA 6	3.6 x 10.0 x 2.2	28	12	8	12	16	20	12
PLAZA 1-2	10.9 x 8.4 x 2.2	120	30	30	40	49	100	80
PLAZA 3-4	12.85 x 9.3 x 2.2	100	30	20	32	40	70	50
PLAZA 3-5	17.15 x 9.5 x 2.2	100	40	30	45	64	100	90
PLAZA 3-6	20.75 x 9.6 x 2.2	200	80	83	65	112	160	160
PLAZA 4-5	10 x 9.8 x 2.2	100	30	30	40	40	70	50
PLAZA 4-6	13.55 x 9.83 x 2.2	120	40	30	54	64	100	70
PLAZA 5-6	7.9 x 10.0 x 2.2	80	22	26	24	36	60	40
PLAZA FLOOR	-	-	-	-	-	-	-	250

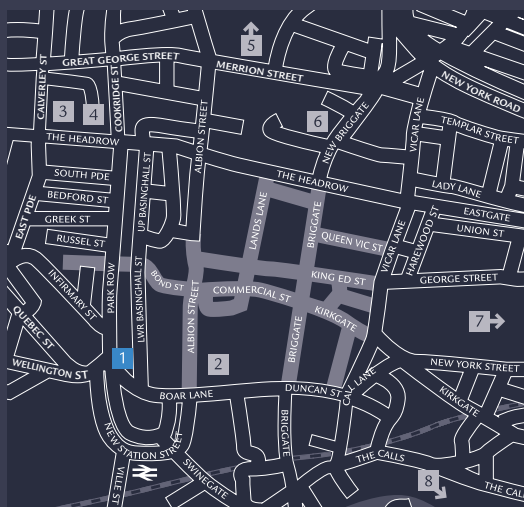

- 1 PARK PLAZA LEEDS
- 2 TRINITY LEEDS
- 3 CITY ART GALLERY
- 4 MILLENNIUM SQUARE
- 5 FIRST DIRECT ARENA
- 6 LEEDS GRAND THEATRE & OPERA HOUSE
- 7 WEST YORKSHIRE PLAYHOUSE
- 8 ROYAL ARMOURIES MUSEUM



PARK PLAZA COUNTY HALL LONDON

WITH A REPUTATION FOR EXCELLENT SERVICE, PARK PLAZA COUNTY HALL LONDON IS AN IMPECCABLE MEETINGS VENUE IN ONE OF LONDON'S MOST ICONIC LOCATIONS.

Conveniently located for Canary Wharf, the City and the West End, Park Plaza County Hall London offers a choice of meeting spaces and private dining in secluded penthouses. All meeting rooms boast natural daylight, modern technology and breakout areas with iconic views.

- Six versatile function suites for up to 100 delegates
- Eight Penthouse Apartments with balconies for meetings and parties
- Spectacular South Bank location close to the London Eye
- 399 spacious guestrooms and suites
- L'Italiano restaurant for great-value classic Italian dishes
- Spectrum Bar and Café for cocktails and nightcaps
- Wellness centre with gym, steam room, sauna and Aurora Spa

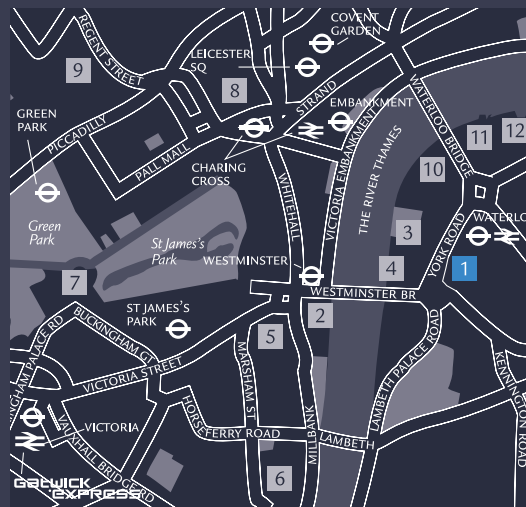

ROOM NAME	DIMENSION W X L X H (M)	THEATRE ROOM	BOARD ROOM	U-SHAPE	CLASS ROOM	CABARET DINNER	DINNER DANCE	RECEPTION
CONFERENCE LEVEL 1								
PUTNEY	5.6 x 5.0 x 2.7	20	12	14	18	16	20	20
WESTMINSTER	5.6 x 7.3 x 2.7	35	18	18	24	24	40	35
PUTNEY AND WESTMINSTER	5.6 x 12.3 x 2.7	70	30	27	48	48	55	80
MILLENNIUM	7.0 x 7.3 x 2.7	50	18	18	24	32	40	50
BATTERSEA	7.0 x 5.0 x 2.7	30	16	14	18	16	20	30
MILLENNIUM AND BATTERSEA	7.0 x 12.3 x 2.7	100	40	36	60	64	80	100
CONFERENCE LEVEL 2								
VAUXHALL	5.6 x 7.3 x 2.7	35	18	18	24	24	40	35
LAMBETH	5.6 x 5.0 x 2.7	20	12	14	18	16	20	20
VAUXHALL AND LAMBETH	5.6 x 12.3 x 2.7	70	30	27	48	48	55	80

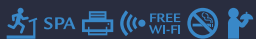

1 Addington Street, London SE1 7RY

T: +44 (0) 333 400 6116 F: +44 (0) 333 400 6117

ppchconf@pphe.com

parkplaza.com/countyhall

- | | | |
|--------------------------------------|------------------------|------------------------|
| 1 PARK PLAZA COUNTY HALL LONDON | 6 TATE BRITAIN GALLERY | 11 NATIONAL THEATRE |
| 2 THE HOUSES OF PARLIAMENT & BIG BEN | 7 BUCKINGHAM PALACE | 12 TATE MODERN GALLERY |
| 3 THE LONDON EYE | 8 NATIONAL GALLERY | |
| 4 LONDON AQUARIUM | 9 REGENT STREET | |
| 5 WESTMINSTER ABBEY | 10 SOUTHBANK CENTRE | |

CONFERENCE LEVEL 1

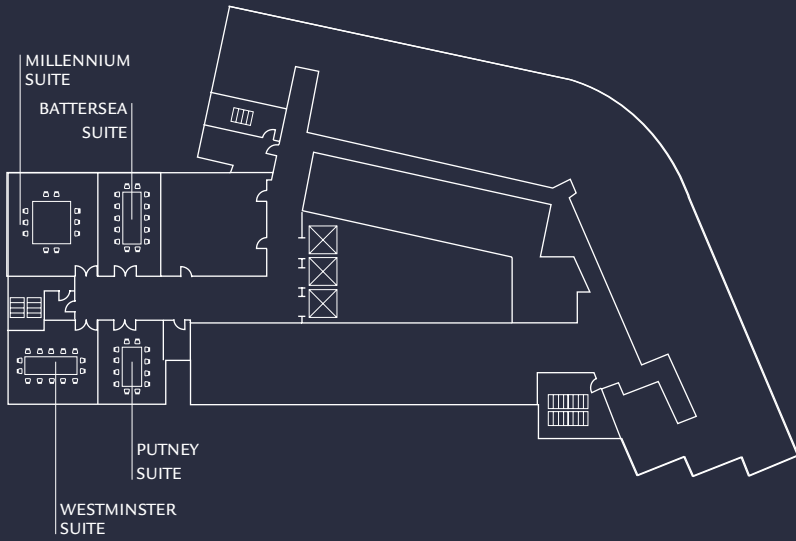

CONFERENCE LEVEL 2

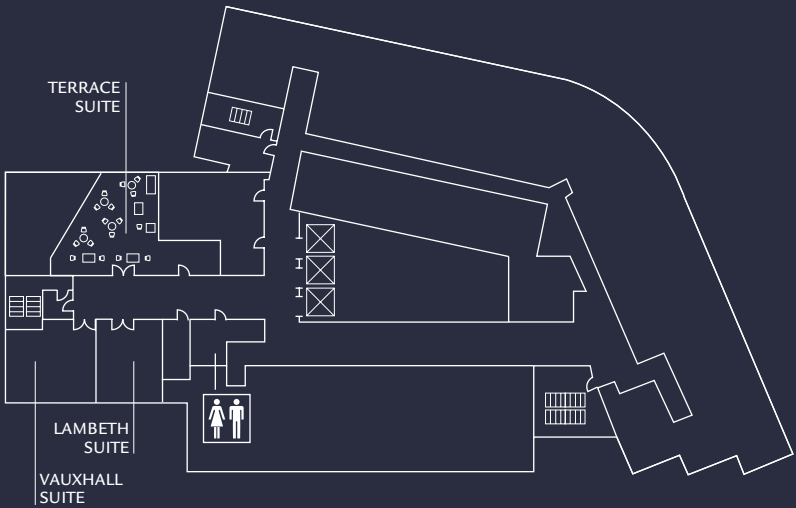

Restrooms

Lift





GROUND FLOOR

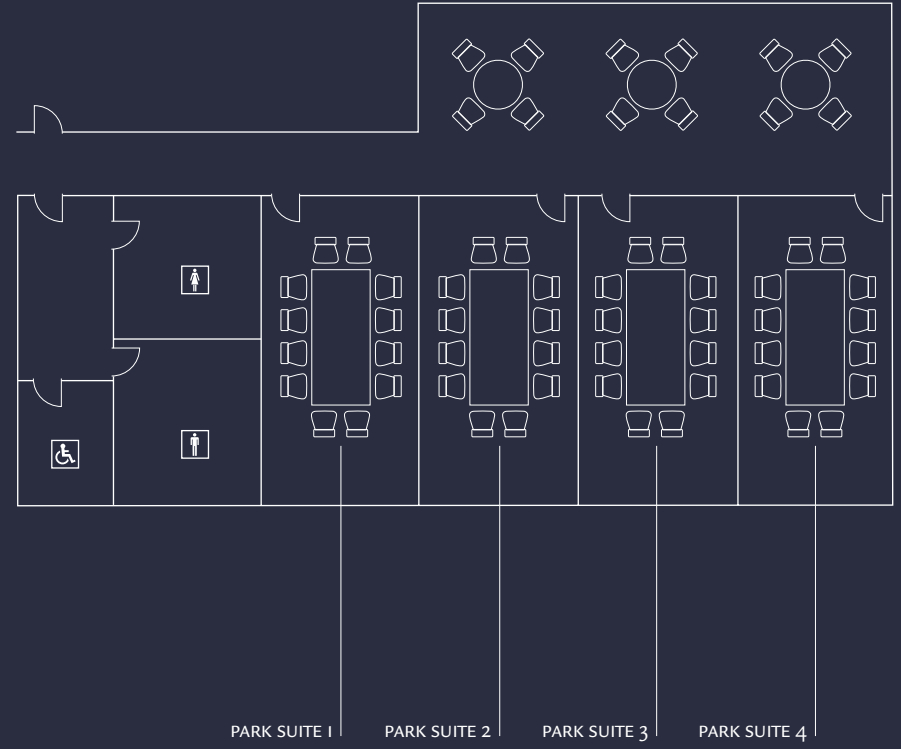

ROOM NAME	DIMENSION W X L X H(M)	THEATRE ROOM	BOARD ROOM	U-SHAPE ROOM	CLASS ROOM	CABARET DINNER	BAN-QUET	RECEPTION
GROUND FLOOR								
PARK SUITE 1	3.5 x 6.1 x 3.1	20	12	-	-	-	-	-
PARK SUITE 2	3.5 x 6.1 x 3.1	20	12	-	-	-	-	-
PARK SUITE 3	3.5 x 6.1 x 3.1	20	12	-	-	-	-	-
PARK SUITE 4	3.5 x 6.1 x 3.1	20	12	-	-	-	-	-
PARK SUITE 1+2	6.9 x 6.1 x 3.1	48	-	15	24	20	40	55
PARK SUITE 3+4	6.9 x 6.1 x 3.1	48	-	15	24	20	40	55



PARK PLAZA LONDON PARK ROYAL

FROM ATTENDING THE POPULAR EVENTS AT WEMBLEY STADIUM TO INDULGING IN DESIGNER RETAIL THERAPY AT WESTFIELD LONDON SHOPPING CENTRE, PARK PLAZA LONDON PARK ROYAL MAJORS ON CONVENIENCE

The hotel is well connected to London's rail network and London Heathrow Airport is within easy reach. Park Plaza London Park Royal offers comfort and convenience in West London with modern facilities and a welcoming atmosphere making it the perfect choice for independent travellers and business guests. Cultural attractions such as Kew Gardens and Chiswick Park are nearby, and the West End entertainment is only a short tube ride away.

- 212 tastefully appointed guest rooms
- Ultra comfortable Park Plaza beds, 48-inch smart LED TVs and walk-in showers
- A total of 84m² of flexible meeting space with natural daylight, individual air-conditioning and state-of-the-art audio-visual equipment
- Movable partitions to create larger spaces with flexible set-ups
- Westway Bar & Kitchen
- 24-hour Fitness Centre



- 1 PARK PLAZA LONDON PARK ROYAL
- 2 PARK ROYAL BUSINESS PARK
- 3 WEMBLEY STADIUM
- 4 SSE WEMBLEY ARENA
- 5 ITV FOUNTAIN STUDIOS
- 6 SUDBURY GOLF CLUB
- 7 HARRY POTTER STUDIOS
- 8 WESTFIELD LONDON

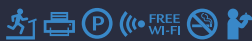

628 Western Avenue, Acton, London W3 0TA
 T: +44 (0) 845 241 3328 F: +44 (0) 845 241 7202
 pppbconf@pphe.com
 parkplaza.com/parkroyal

PARK PLAZA LONDON RIVERBANK

A STUNNING CONFERCING SOLUTION INCLUDING CUSTOMISABLE SPACE, DEDICATED EVENTS TEAMS AND CUTTING-EDGE TECHNOLOGY.

Effortlessly stylish, Park Plaza Riverbank London is one of the capital's most comprehensive meetings and events venues, with a multitude of flexible meeting rooms. From product launches to major conferences and society weddings, the hotel offers outstanding facilities and world-class service.

- 20 meeting rooms in a self-contained conference centre
- Experienced on-site audio-visual and meeting planners
- Hi-tech audio-visual equipment, rigging points and car lift access
- Ballroom, Plaza and Park Suites with multiple configurations
- Luxury private suites with balconies for private functions
- Dedicated check-in area and drop-off for coaches and cars
- Overlooking Millbank on the south side of the River Thames
- 395 contemporary guestrooms, Executive Rooms and suites
- Award-winning Chino Latino® Pan-Asian Restaurant & Bar
- Club Lounge for private dining
- Licensed for weddings and civil ceremonies

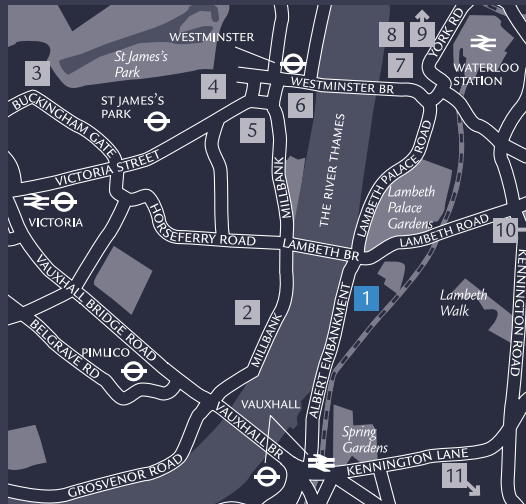

- | | | |
|--------------------------------------|---|-----------------------------------|
| 1 PARK PLAZA LONDON RIVERBANK | 6 THE HOUSES OF PARLIAMENT & BIG BEN | 11 THE OVAL CRICKET GROUND |
| 2 TATE BRITAIN | 7 LONDON AQUARIUM | |
| 3 BUCKINGHAM PALACE | 8 THE LONDON EYE | |
| 4 QEII CONFERENCE CENTRE | 9 ROYAL FESTIVAL HALL | |
| 5 WESTMINSTER ABBEY | 10 IMPERIAL WAR MUSEUM | |

ROOM NAME	DIMENSION W X L X H (M)	THEATRE	BOARD ROOM	U-SHAPE	CLASS ROOM	CABARET	DINNER	DINNER DANCE	RECEPTION
CONFERENCE LEVEL -2									
THE BALLROOM	22.9 x 27.9 x 5	650	-	-	450	432	540	490	660
<i>The ballroom can also be divided into two separate ballrooms</i>									
BALLROOMS	22.9 x 13.9 x 5	300	-	54	216	200	250	200	450
CONFERENCE LEVEL -4									
THE PLAZA SUITE	24.5 x 22.8 x 2.3	550	-	-	330	304	400	340	550
<i>The plaza suite can also be split into variable syndicate rooms</i>									
SINGLE PLAZA ROOM	9.5 x 4.5 x 3.95	40	22	-	24	32	30	-	40
DOUBLE PLAZA ROOM	9.5 x 9.0 x 3.95	80	32	23	48	56	60	-	80
TRIPLE PLAZA ROOM	9.5 x 13.5 x 3.95	120	40	30	60	88	90	60	120
QUADRUPLE PLAZA ROOM	9.5 x 18 x 3.95	160	-	-	72	110	120	90	160
HALF THE PLAZA SUITE	9.5 x 22.5 x 3.95	200	-	-	84	140	180	150	200
MEZZANINE LEVEL — PARK SUITES & BUSINESS CENTRE									
PARK SUITE 1	5.8 x 4.3 x 2.3	15	10	-	-	-	10	-	-
PARK SUITE 2	5.1 x 4.9 x 2.3	20	14	-	-	-	14	-	-
PARK SUITE 3	5.8 x 4.3 x 2.3	15	10	-	-	-	10	-	-
PARK SUITE 4	6.0 x 4.8 x 2.3	24	14	-	-	-	14	-	-
PARK SUITE 5	5.9 x 3.6 x 2.3	18	10	-	-	-	10	-	-
PARK SUITE 6	4.3 x 3.6 x 2.3	-	10	-	-	-	10	-	-
PARK SUITE 7	5.4 x 3.9 x 2.3	12	10	-	-	-	10	-	-
PARK SUITE 8	4.0 x 3.9 x 2.3	10	6	-	-	-	6	-	-
GROUND FLOOR — CITY SUITES									
CITY SUITE	12.5 x 24.5	380	-	-	135	200	250	264	400
CITY SUITE 1	12.5 x 12.2	120	-	45	75	96	120	120	120
CITY SUITE 2	12.5 x 6.1	60	-	27	30	48	60	-	60
CITY SUITE 3	12.5 x 6.2	60	-	27	30	48	60	-	60
CITY SUITE 1-2	12.5 x 18.3	180	-	54	105	144	150	120	180
CITY SUITE 2-3	12.5 x 12.3	150	-	45	60	96	120	100	150



18 Albert Embankment, London SE1 7TJ

T: +44 (0) 333 400 6120 F: +44 (0) 333 400 6121

pprconf@pphe.com

parkplaza.com/riverbank

CONFERENCE LEVEL -2

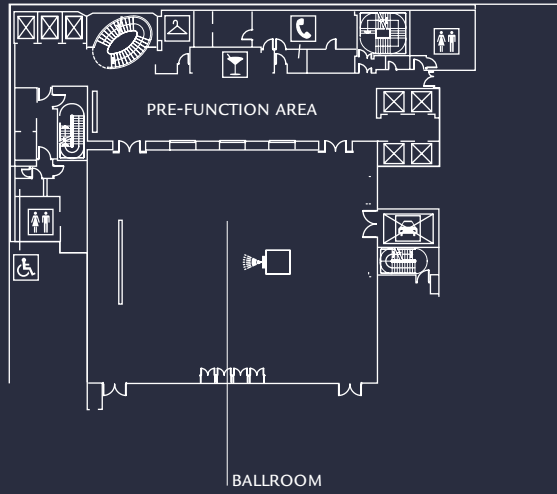



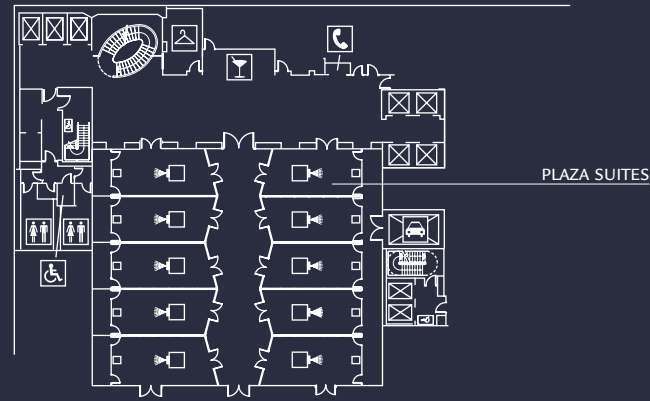



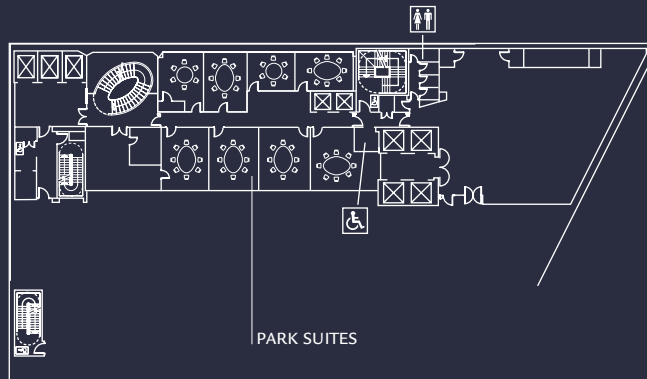

CONFERENCE LEVEL -4



MEZZANINE LEVEL



-  Male WC
-  Female WC
-  Accessible WC
-  Cloakroom
-  Bar
-  Telephone
-  Projector available on request
-  Service Lift
-  Lift





PARK SUITES

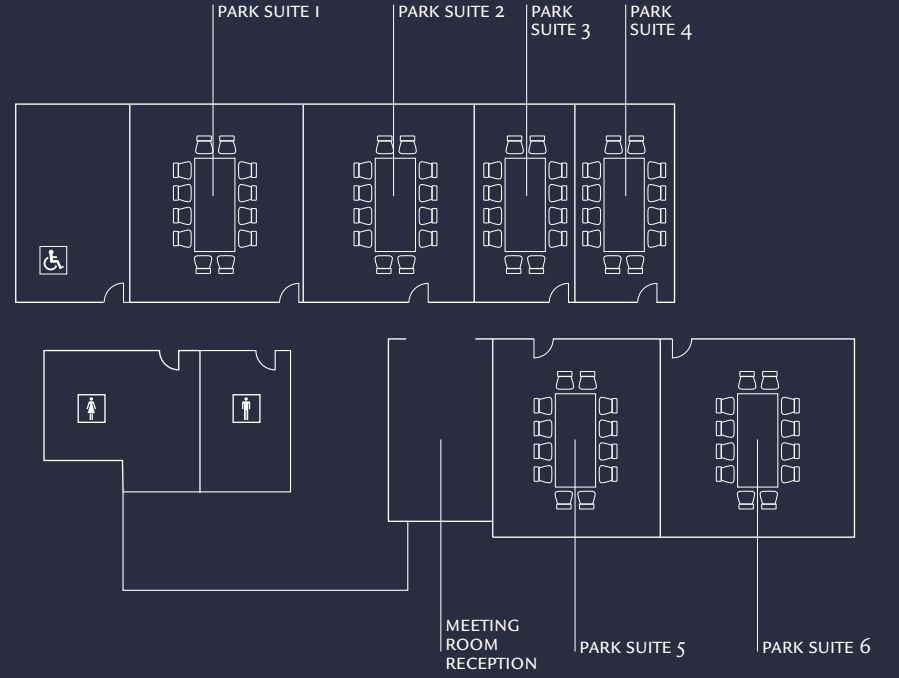

Female WC

Male WC

Accessible WC

ROOM NAME	DIMENSION W X L X H(M)	THEATRE ROOM	BOARD ROOM	U-SHAPE ROOM	CLASS ROOM	CABARET DINNER	DINNER DANCE	RECEP- TION
GROUND FLOOR								
PARK SUITE 1	5.0 x 7.0 x 2.8	40	16	16	20	24	30	-
PARK SUITE 2	5.0 x 7.0 x 2.8	40	16	16	20	24	30	-
PARK SUITE 3	5.0 x 3.5 x 2.8	20	14	-	6	12	-	-
PARK SUITE 4	5.0 x 3.5 x 2.8	20	14	-	6	12	-	-
PARK SUITE 5	5.2 x 7.0 x 2.8	40	16	16	20	24	30	-
PARK SUITE 6	10.1 x 6.7 x 2.8	40	16	16	20	24	30	-
PARK SUITE 1-2	5.0 x 14.0 x 2.8	90	32	32	40	48	60	-
PARK SUITE 1-3	5.0 x 17.5 x 2.8	120	45	51	46	72	80	70
PARK SUITE 1-4	5.0 x 21.0 x 2.8	150	54	60	52	96	130	100
PARK SUITE 2-3	5.0 x 10.5 x 2.8	70	28	26	26	40	40	-
PARK SUITE 2-4	5.0 x 14.0 x 2.8	90	40	32	32	48	60	-
PARK SUITE 3-4	5.0 x 7.0 x 2.8	40	16	16	12	24	30	-
PARK SUITE 5-6	5.2 x 14.0 x 2.8	90	36	36	40	48	60	-
PARK SUITE 5-6 + FOYER	5.2 x 18.0 x 2.8	-	-	-	-	-	-	-



PARK PLAZA LONDON WATERLOO

**LOCATED CLOSE TO LONDON WATERLOO STATION
THE HOTEL IS WITHIN WALKING DISTANCE OF
LEADING ATTRACTIONS**

With modern facilities and superior service, the hotel is the epitome of comfort, welcoming leisure and business travellers alike. The South Bank is one of London's most creative areas, with nearly two miles of arts and entertainment venues. The nearby London Waterloo Station also offers easy connections to the City and to the South of England.

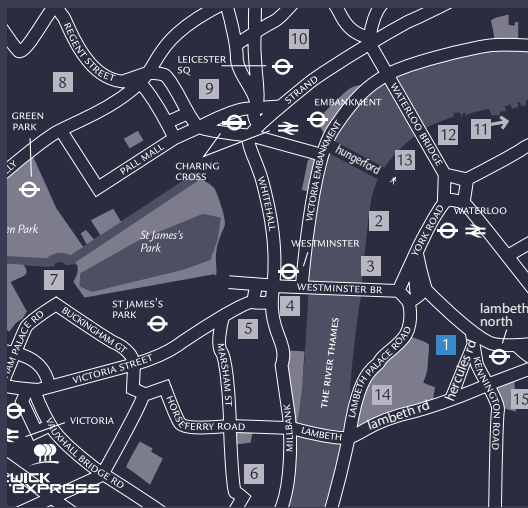

- 494 stylish design-led guest rooms
- Ultra comfortable Park Plaza beds, 48-inch smart LED TVs, Elemis bathroom amenities
- Executive Lounge on the 12th floor
- Six meeting rooms collectively offer a space of up to 405m² and cater for up to 310 delegates theatre style
- Pre-function area for welcome and registration as well as meeting breakouts
- Mandara Spa with indoor heated pool
- Fitness centre
- Florentine Restaurant & Bar offers an all-day dining experience
- illy Caffè for the finest quality coffee

- | | | |
|--------------------------------------|-----------------------------------|------------------------|
| 1 PARK PLAZA LONDON WATERLOO | 6 TATE BRITAIN GALLERY | 11 TATE MODERN GALLERY |
| 2 THE LONDON EYE | 7 BUCKINGHAM PALACE | 12 NATIONAL THEATRE |
| 3 SEA LIFE LONDON AQUARIUM | 8 REGENT STREET | 13 SOUTHBANK CENTRE |
| 4 THE HOUSES OF PARLIAMENT & BIG BEN | 9 NATIONAL GALLERY | 14 LAMBETH PALACE |
| 5 WESTMINSTER ABBEY | 10 THEATRE LAND AND COVENT GARDEN | 15 IMPERIAL WAR MUSEUM |



6 Hercules Road, London SE1 7DP
 T: +44 (0) 333 400 6128 F: +44 (0) 333 400 6129
 ppmeetings@pphe.com
 parkplaza.com/waterloo

PARK PLAZA VICTORIA LONDON

DESIGN-LED DÉCOR COMBINES WITH BEST-IN-CLASS TECHNOLOGY, ACCOMMODATION AND DINING TO CREATE AN OUTSTANDING MEETINGS AND CONFERENCING SOLUTION.

From product launches to wedding receptions, Park Plaza Victoria London offers a dedicated conferencing centre with 14 flexible meeting rooms complemented by an extensive exhibition area for trade shows and corporate events, all within easy reach of London's rail and airport links.

- 14 versatile meeting rooms in a self-contained facility
- Breathtaking 600m² Victoria Suite for up to 750 guests
- Soundproofed conference and exhibitions area for 30 stands
- Two ballrooms for large weddings and social gatherings
- Licensed for weddings and civil ceremonies
- Close to Victoria Station and the capital's key transport hubs
- 299 chic guestrooms and 12 luxurious apartments
- TOZI, a vibrant Italian restaurant and cocktail bar specialising in Venetian cicchetti, adjacent to the hotel
- The Lounge Bar for speciality cocktails, bar snacks and coffees
- Fitness suite and beauty treatment room

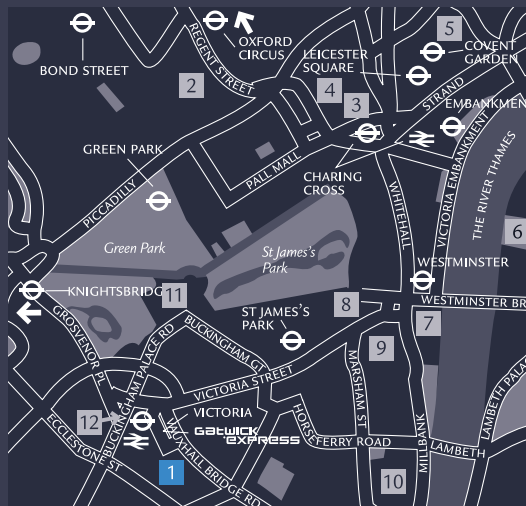

ROOM NAME	DIMENSION W X L X H (M)	THEATRE	BOARD ROOM	U- SHAPE	CLASS ROOM	CABARET DINNER	DINNER DANCE	RECEP- TION
CONFERENCE LEVEL 1								
VICTORIA SUITE	23.8 x 25.5 x 3.5	550	-	-	260	280	400	750
VICTORIA 1	23.8 x 12.9 x 3.5	250	-	50	120	120	210	350
VICTORIA 2	23.8 x 12.6 x 3.5	220	-	50	108	100	180	250
BEATRICE SUITE	-	-	-	-	-	-	220	400
BEATRICE 1	14.9 x 14.1 x 3.6	166	40	41	60	88	120	200
BEATRICE 2	20.9 x 9.3 x 2.4	140	50	-	60	80	110	200
CONFERENCE LEVEL 2								
EDWARD SUITE	10.1 x 38.4 x 3.1	300	-	-	153	-	280	400
EDWARD 1	10.1 x 5.2 x 3.1	45	24	24	24	32	40	45
EDWARD 2	10.1 x 5.2 x 3.1	45	24	24	24	32	40	45
EDWARD 3	10.1 x 5.2 x 3.1	45	24	24	24	32	40	45
EDWARD 4	10.1 x 5.2 x 3.1	45	24	24	24	32	40	45
EDWARD 5	10.1 x 5.2 x 3.1	45	24	24	24	32	40	45
EDWARD 6	10.1 x 5.2 x 3.1	45	24	24	24	32	40	45
EDWARD 7	10.1 x 7.2 x 3.1	60	24	28	30	40	50	65
EDWARD 1 AND 2	10.1 x 10.4 x 3.1	90	36	36	36	56	80	90
EDWARD 3 AND 4	10.1 x 10.4 x 3.1	90	36	36	36	56	80	90
EDWARD 5 AND 6	10.1 x 10.4 x 3.1	90	36	36	36	56	80	90
EDWARD 1-3	10.1 x 15.6 x 3.1	150	50	50	63	96	140	150
EDWARD 1-4	10.1 x 20.8 x 3.1	200	64	64	90	120	160	200
EDWARD 6-7	10.1 x 12.4 x 3.1	120	36	36	45	64	90	120
EDWARD 5-7	10.1 x 17.6 x 3.1	160	50	50	63	104	140	150
EDWARD 4-7	10.1 x 22.8 x 3.1	220	64	64	99	136	180	220
ALBERT SUITE	9.6 x 18.5 x 3.1	140	-	56	60	96	120	150
ALBERT 1	8.9 x 6.3 x 3.1	40	22	16	18	24	30	40
ALBERT 2	9.6 x 6.3 x 3.1	45	22	20	24	32	30	45
ALBERT 3	9.6 x 5.9 x 3.1	45	22	20	24	32	30	45
ALBERT 1 AND 2	9.5 x 12.6 x 3.1	85	28	36	36	56	70	80
ALBERT 2 AND 3	9.5 x 12.2 x 3.1	90	34	36	36	64	80	90
THE EXECUTIVE BOARDROOM	8.0 x 5.5 x 3.0	-	15	-	-	-	-	-



239 Vauxhall Bridge Road, London SW1V 1EQ

T: +44 (0) 333 400 6140 F: +44 (0) 333 400 6141

ppvlconf@pphe.com

parkplaza.com/victorialondon

- | | | |
|-------------------------------------|---|---------------------------------|
| 1 PARK PLAZA VICTORIA LONDON | 6 LONDON EYE | 11 BUCKINGHAM PALACE |
| 2 REGENT STREET | 7 THE HOUSES OF PARLIAMENT & BIG BEN | 12 ORIENT EXPRESS TRAINS |
| 3 NATIONAL GALLERY | 8 QEII CONFERENCE CENTRE | |
| 4 LEICESTER SQUARE | 9 WESTMINSTER ABBEY | |
| 5 COVENT GARDEN | 10 TATE BRITAIN GALLERY | |

CONFERENCE LEVEL 1

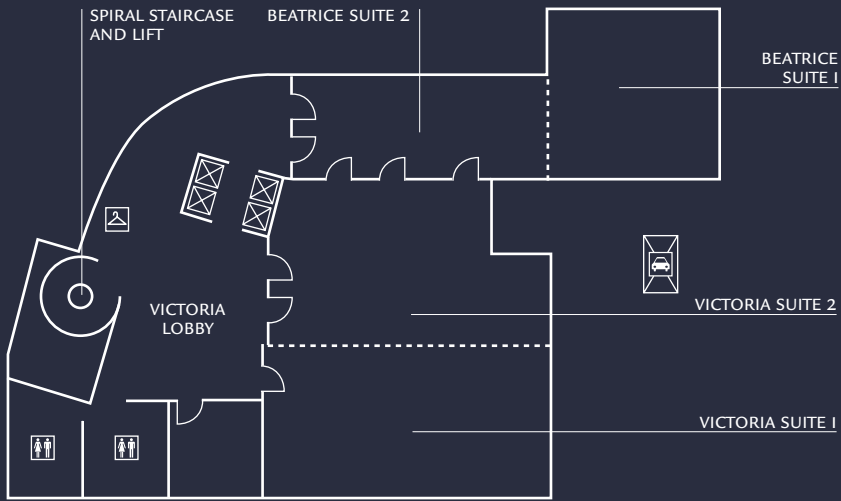

CONFERENCE LEVEL 2

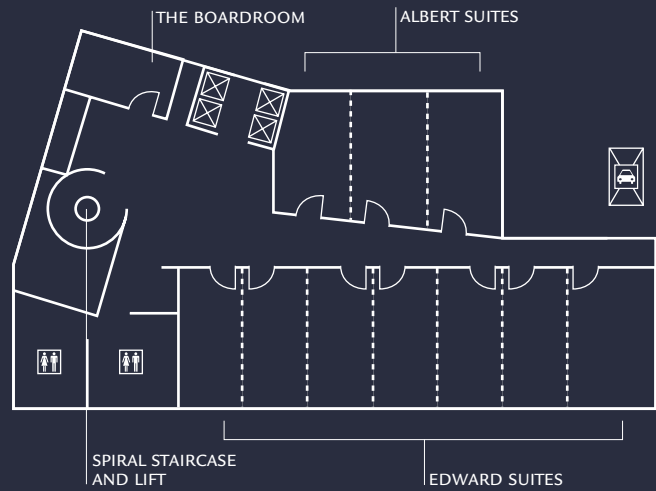

-  Restrooms
-  Cloakroom
-  Service Lift
-  Lift





WESTMINSTER BALLROOM

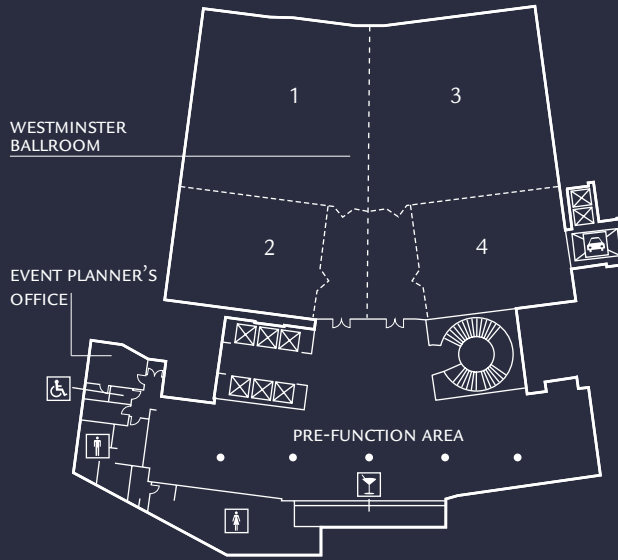

LOWER GROUND FLOOR

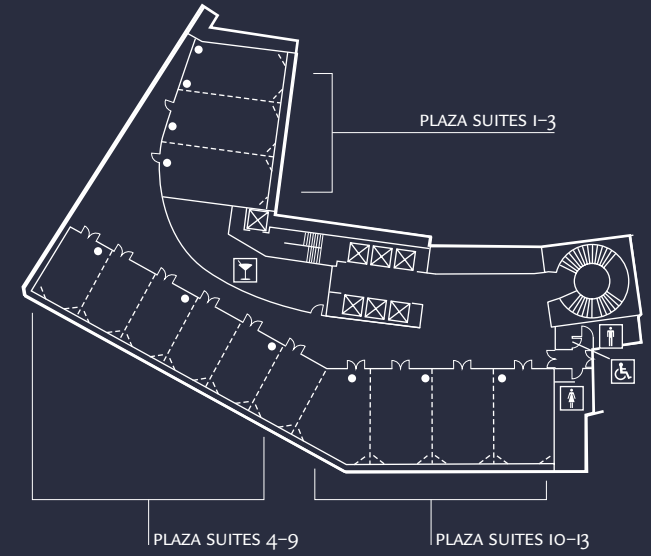



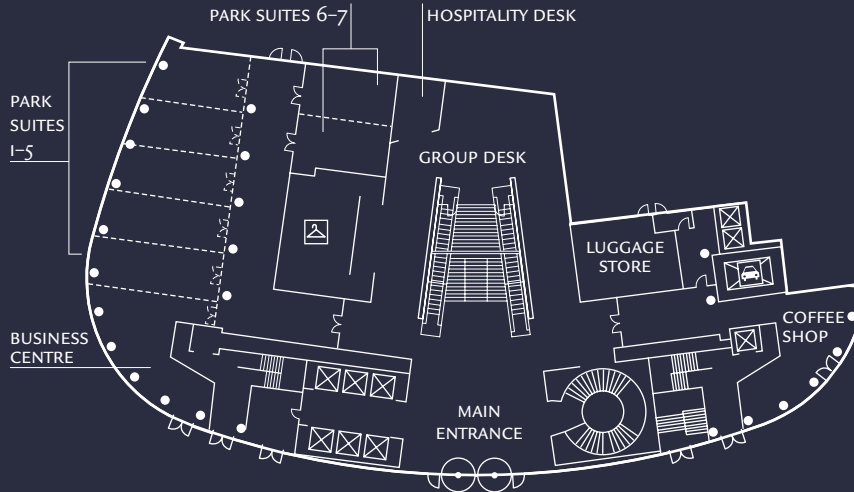

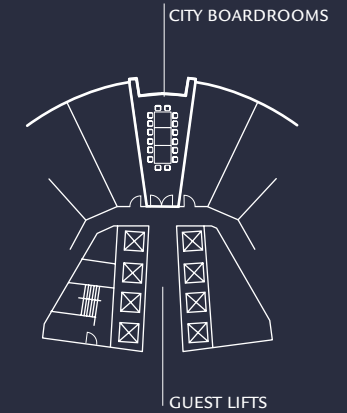

GROUND FLOOR



FLOORS 2 - 12



-  Male WC
-  Female WC
-  Accessible WC
-  Cloakroom
-  Bar
-  Lift
-  Service Lift

ROOM NAME	DIMENSION W X L X H (M)	THEATRE	BOARD ROOM	U- SHAPE	CLASS ROOM	CABARET ROOM	DINNER ROOM	DINNER DANCE	RECEP- TION
WESTMINSTER BALLROOM									
WESTMINSTER BALLROOM	31.2 x 37.4 x 5.3	2000	-	-	700	720	1350	1220	1500
ROOM 1	18.5 x 17.8 x 5.3	350	-	-	170	225	240	160	300
ROOM 2	12.4 x 14.9 x 5.3	200	-	-	100	144	120	100	200
ROOM 3	18.5 x 17.8 x 5.3	350	-	-	170	225	240	160	300
ROOM 4	12.4 x 14.9 x 5.3	200	-	-	100	144	120	100	160
ROOM 1 + 2	31.2 x 18.7 x 5.3	700	-	-	350	342	580	480	700
ROOM 1 + 3	36.0 x 18.5 x 5.3	800	-	-	400	405	630	350	600
ROOM 3 + 4	31.2 x 18.7 x 5.3	700	-	-	350	342	580	480	700
PRE-FUNCTION AREA	5.3 (H)	-	-	-	-	-	220	-	570
LOWER GROUND FLOOR									
PLAZA SUITE 1	9.5 x 5.2 x 3.4	55	20	24	24	21	30	-	40
PLAZA SUITE 2	10.5 x 5.4 x 3.4	62	24	26	27	24	30	-	50
PLAZA SUITE 3	10.8 x 5.3 x 3.4	70	26	26	30	24	30	-	60
PLAZA SUITE 4	7.5 x 4.9 x 3.4	32	16	18	18	16	20	-	35
PLAZA SUITE 5	7.5 x 4.9 x 3.4	45	20	18	24	16	20	-	45
PLAZA SUITE 6	7.5 x 4.8 x 3.4	43	16	18	24	16	20	-	40
PLAZA SUITE 7	7.5 x 4.8 x 3.4	48	20	20	27	16	20	-	46
PLAZA SUITE 8	7.5 x 4.8 x 3.4	44	20	18	27	16	20	-	40
PLAZA SUITE 9	7.5 x 4.8 x 3.4	46	20	20	27	16	20	-	46
PLAZA SUITE 10	8.8 x 6.2 x 3.4	60	24	22	27	24	30	-	60
PLAZA SUITE 11	9.5 x 6.1 x 3.4	64	26	24	30	24	30	-	60
PLAZA SUITE 12	9.5 x 6.1 x 3.4	64	26	24	30	24	30	-	60
PLAZA SUITE 13	9.5 x 6.1 x 3.4	70	26	24	30	24	30	-	60
PLAZA SUITE 1-3	16.1 x 10.2 x 3.4	150	40	40	90	90	180	-	250
PLAZA SUITE 4-9	30.0 x 7.5 x 3.4	200	-	-	108	126	150	120	250
PLAZA SUITE 10-13	24.5 x 9.5 x 3.4	250	40	-	98	135	150	100	250
PLAZA SUITE (WHOLE SUITE)	113.0 x 4.8 x 3.4	-	-	-	-	-	-	-	1000
PLAZA SUITE FOYER	3.4 (H)	-	-	-	-	-	-	-	200
GROUND FLOOR									
PARK SUITE 1	5.4 x 4.6 x 3.2	20	10	9	12	-	10	-	20
PARK SUITE 2	6.5 x 3.8 x 3.2	30	14	11	15	-	10	-	25
PARK SUITE 3	7.6 x 3.8 x 3.2	34	16	13	18	16	20	-	30
PARK SUITE 4	8.5 x 3.8 x 3.2	40	16	15	24	16	20	-	35
PARK SUITE 5	8.8 x 3.9 x 3.2	40	16	15	24	16	20	-	40
PARK SUITE 6	6.8 x 4.3 x 2.8	30	16	13	18	16	20	-	25
PARK SUITE 7	6.8 x 4.0 x 2.8	30	16	13	18	16	20	-	25
PARK SUITE 1-5	20.5 x 7.6 x 3.2	170	40	44	74	80	120	-	160
PARK SUITE 6+7	6.8 x 8.4 x 2.8	70	24	21	36	24	30	-	72
PARK SUITE FOYER	23.6 x 5.0 x 3.2	-	-	-	-	-	-	-	-
FLOORS 2-12									
CITY ROOMS 2-12	9.2 x 3.1 x 2.3	26	16	-	-	-	-	-	-

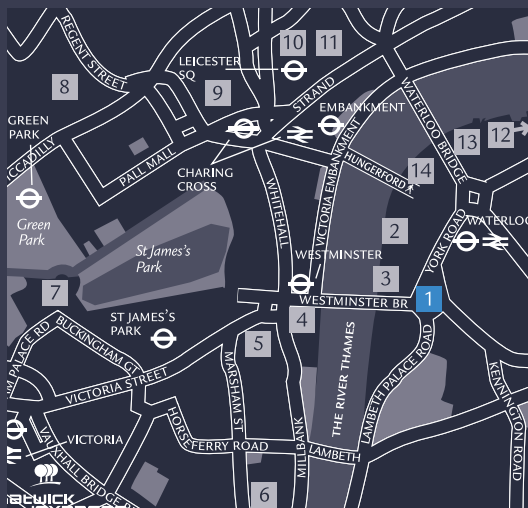

- 1 PARK PLAZA WESTMINSTER BRIDGE LONDON
- 2 THE LONDON EYE
- 3 LONDON AQUARIUM
- 4 THE HOUSES OF PARLIAMENT & BIG BEN
- 5 WESTMINSTER ABBEY
- 6 TATE BRITAIN GALLERY
- 7 BUCKINGHAM PALACE
- 8 REGENT STREET
- 9 NATIONAL GALLERY
- 10 THEATRE LAND
- 11 COVENT GARDEN
- 12 TATE MODERN GALLERY
- 13 NATIONAL THEATRE
- 14 SOUTHBANK CENTRE

PARK PLAZA WESTMINSTER BRIDGE LONDON

ART MEETS DESIGN TO CREATE AN UNPARALLELED MEETINGS AND CONFERENCE SOLUTION ON THE BANKS OF THE ICONIC RIVER THAMES

The spectacular Park Plaza Westminster Bridge London overlooks Big Ben and the Houses of Parliament on London's South Bank. An all-in-one solution for meetings, conferences and private gatherings, the hotel boasts a 1,200m² pillar-free ballroom, flexible meeting suites and intimate City Boardrooms.

- Breathtaking Westminster Ballroom for up to 2,000 delegates theatre-style
- Flexible Plaza and Park suites for meetings for up to 250 guests
- Exclusive City Boardrooms with floor-to-ceiling windows
- Dedicated coach parking, group check-in and high-level security
- Licensed for weddings and civil ceremonies
- Minutes from the City of London and the glamorous West End
- 1,019 tasteful guestrooms, suites and Penthouse Apartments
- Block booking available for conference delegates
- Five unique restaurants and bars offering international cuisine
- Mandara Spa and fitness centre with indoor swimming pool

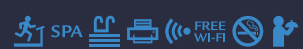

200 Westminster Bridge Road, London SE1 7UT
 T: +44 (0) 333 400 6112 F: +44 (0) 333 400 6113
 ppwlconf@pphe.com
 parkplaza.com/westminsterbridge

PARK PLAZA NOTTINGHAM

A VERSATILE MEETINGS AND EVENTS VENUE FOR UP TO 220 GUESTS CLOSE TO NOTTINGHAM'S VIBRANT CITY CENTRE AND KEY COMMERCIAL DISTRICTS

Close to the UK's major motorways and East Midlands Airport, Park Plaza Nottingham is ideal for meetings, conferences, weddings and social gatherings. With neutral décor, natural daylight and Wi-Fi, all meeting rooms combine to form a conference suite with stunning city views.

- 12 meeting rooms offering up to 400m² of event space
- Five syndicate rooms, four of which can form the Vista Suite
- Convenient for Nottingham's main attractions and Sherwood Forest
- 178 contemporary guestrooms, including Executive Rooms and Junior Suites
- Award-winning Chino Latino® Pan-Asian Restaurant & Bar
- Fitness suite with weight-resistance and cardiovascular equipment

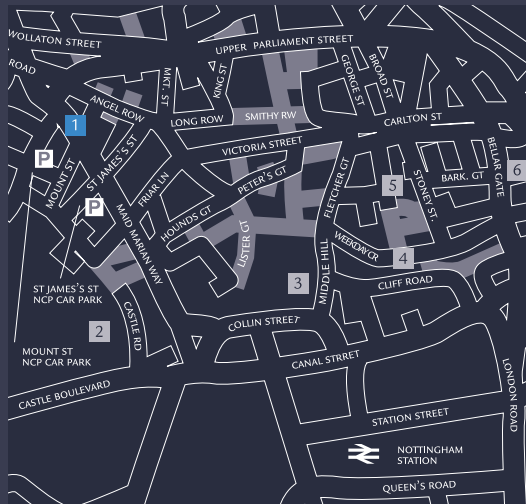

ROOM NAME	DIMENSION W X L X H(M)	THEATRE ROOM	BOARD ROOM	U-SHAPE ROOM	CLASS ROOM	CABA-RET	DINNER DANCE	DINNER RECEPTION	
ELEVENTH FLOOR									
VISTA 1	6.0 x 9.0 x 2.2	45	14	18	16	24	30	-	-
VISTA 2	6.0 x 9.0 x 2.2	45	14	18	16	24	30	-	-
VISTA 3	6.0 x 9.0 x 2.2	45	14	18	16	24	30	-	-
VISTA 4	6.0 x 9.0 x 2.2	45	14	18	16	24	30	-	-
VISTA 5	7.0 x 9.0 x 2.2	50	16	20	20	32	40	-	-
VISTA 1 AND 2	12.0 x 9.0 x 2.2	90	24	32	32	48	60	-	-
VISTA 2 AND 3	12.0 x 9.0 x 2.2	90	24	32	32	48	60	-	-
VISTA 3 AND 4	11.0 x 9.0 x 2.2	90	24	32	32	48	60	-	-
VISTA 1-3	18.0 x 9.0 x 2.2	135	32	42	50	72	90	-	150
VISTA 2-4	17.0 x 9.0 x 2.2	135	32	42	50	72	90	-	-
VISTA 1-4	23.0 x 9.0 x 2.2	200	-	-	90	120	170	-	-
UPPER GROUND FLOOR									
PLAZA SUITE	10.0 x 13.0 x 2.2	100	30	42	40	72	80	-	-
SYNDICATE BEDROOMS	-	20	10	-	-	-	-	-	-



41 Maid Marian Way, Nottingham NG1 6GD

T: +44 (0) 333 400 6148 F: +44 (0) 333 400 6149

ppnconf@pphe.com

parkplaza.com/nottingham

1 PARK PLAZA NOTTINGHAM

6 MOTORPOINT ARENA

2 NOTTINGHAM CASTLE

3 THE CAVES OF NOTTINGHAM

4 NATIONAL JUSTICE MUSEUM

5 THE LACE MARKET

ELEVENTH FLOOR

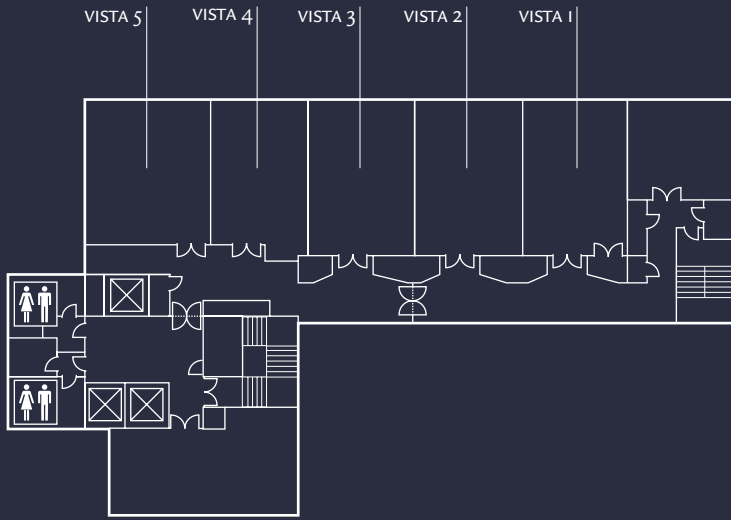

UPPER GROUND FLOOR

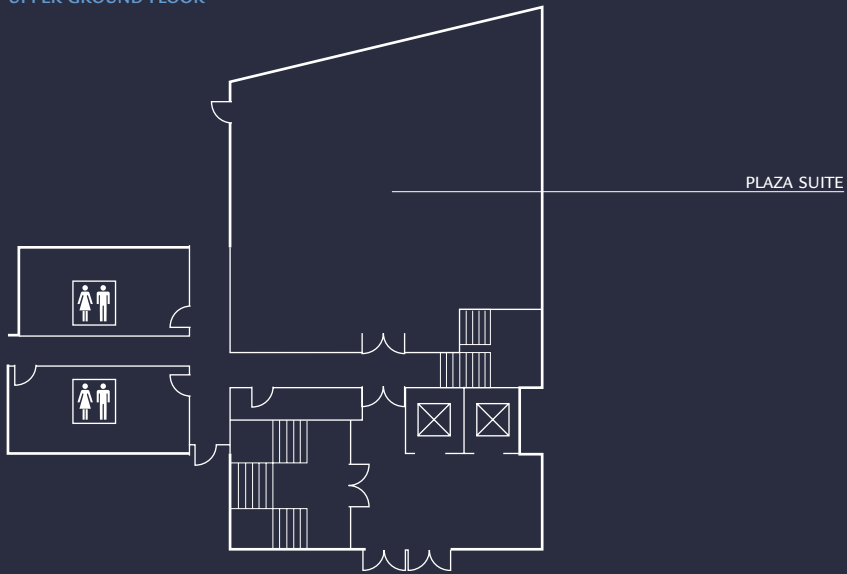

Restrooms

Lift



PLAZA ON THE RIVER™

LONDON

LONDON'S LEADING FIVE-STAR ALL-SUITE SOLUTION WITH DISCREET PERSONAL SERVICE AND PANORAMIC CITY AND RIVER VIEWS

Situated opposite Tate Britain, Plaza on the River™ overlooks the Houses of Parliament, Big Ben and the London Eye. Offering contemporary open-plan studios and suites, this exceptional venue partners with Park Plaza Riverbank London to stage bespoke meetings, conferences and private celebrations.

- Access to 20 meeting rooms at the adjacent Park Plaza Riverbank London
- Glorious location on the Albert Embankment in the heart of London
- 65 spacious open-plan studios and suites
- All suites have designated lounge, kitchen, bedroom and bathroom
- Pre-arrival grocery stocking and personal shopping service
- Award-winning Chino Latino® Pan-Asian Restaurant & Bar
- Contemporary fitness suite and pampering in-room spa menu

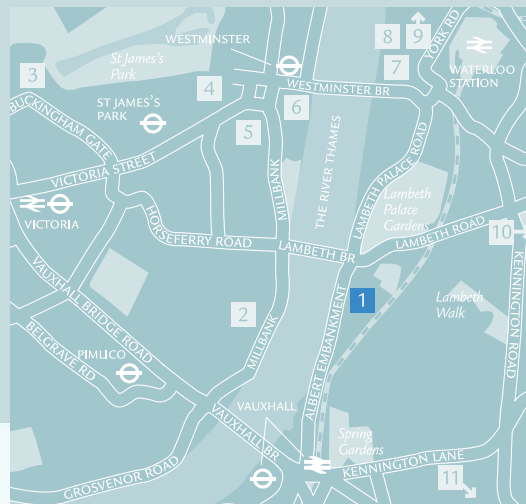

18 Albert Embankment, London SE1 7TJ

T: +44 (0) 333 400 6124 F: +44 (0) 333 400 6125

pprlconf@pphe.com

plazaontheriver.co.uk

- | | | |
|--------------------------|--------------------------------------|----------------------------|
| 1 PLAZA ON THE RIVER | 6 THE HOUSES OF PARLIAMENT & BIG BEN | 11 THE OVAL CRICKET GROUND |
| 2 TATE BRITAIN | 7 LONDON AQUARIUM | |
| 3 BUCKINGHAM PALACE | 8 THE LONDON EYE | |
| 4 QEII CONFERENCE CENTRE | 9 ROYAL FESTIVAL HALL | |
| 5 WESTMINSTER ABBEY | 10 IMPERIAL WAR MUSEUM | |

CONTACT US

Visit us online, contact the hotel directly or call us toll free. We're looking forward to your call.

sales@pphe.com

GDS Chain Code: PK

Toll Free (00) 800 814 70000*

For a complete overview visit
parkplaza.com/contactus

*some phone operators do not grant access to 00800 numbers or may charge a fee

parkplaza.com



GET IN TOUCH



Connect with us online
parkplaza.com/stayintouch



[#parkplazamoments](https://twitter.com/parkplazamoments)

parkplaza.com

